



BUILDING A BETTER I-4

Stay Informed:

- » Project Hotline: 844-ULT-INFO (858-4636)
- » Sign up for email and text alerts at fdot.tips/I4Alerts
- » Follow @i4Ultimate on Twitter
- » Subscribe to our monthly newsletter at fdot.tips/I4News

EASTBOUND & WESTBOUND I-4 THROUGH DOWNTOWN ORLANDO CLOSING NIGHT OF MARCH 22

NIGHTTIME CLOSURE OF EASTBOUND INTERSTATE 4 (I-4) BETWEEN GORE STREET AND STATE ROAD (S.R.) 408 AND WESTBOUND I-4 BETWEEN COLONIAL DRIVE AND S.R. 408

The Florida Department of Transportation is temporarily closing at night eastbound I-4 between Gore Street and S.R. 408. The roadway will close at 11 p.m. on Friday, March 22 and will reopen by 5 a.m. the following morning. Law enforcement officers will monitor each signalized intersection on the detour route of Garland Avenue between S.R. 408 and Colonial Drive to promote traffic flow. The eastbound I-4 entrance ramp from eastbound S.R. 408 also will be closed from 11 p.m. to 5 a.m. The eastbound I-4 entrance ramps from Anderson Street and westbound S.R. 408 will remain open. See reverse side for westbound I-4 closure information and detour map. The closures are necessary for bridge work. Closures are dependent on weather and other conditions.

Traveling eastbound on I-4:

- Exit eastbound I-4 at Exit 82B onto South Street
- Continue northbound on Garland Avenue
- Enter eastbound I-4 from Garland Avenue just beyond Concord Street

Traveling to eastbound I-4 from eastbound State Road (S.R.) 408:

- Exit eastbound S.R. 408 at Exit 9 onto Orange Blossom Trail (U.S. 441-17/92)
- Turn left onto Orange Blossom Trail
- Turn right onto Colonial Drive
- Follow signs to enter eastbound I-4 from Colonial Drive and Garland Avenue

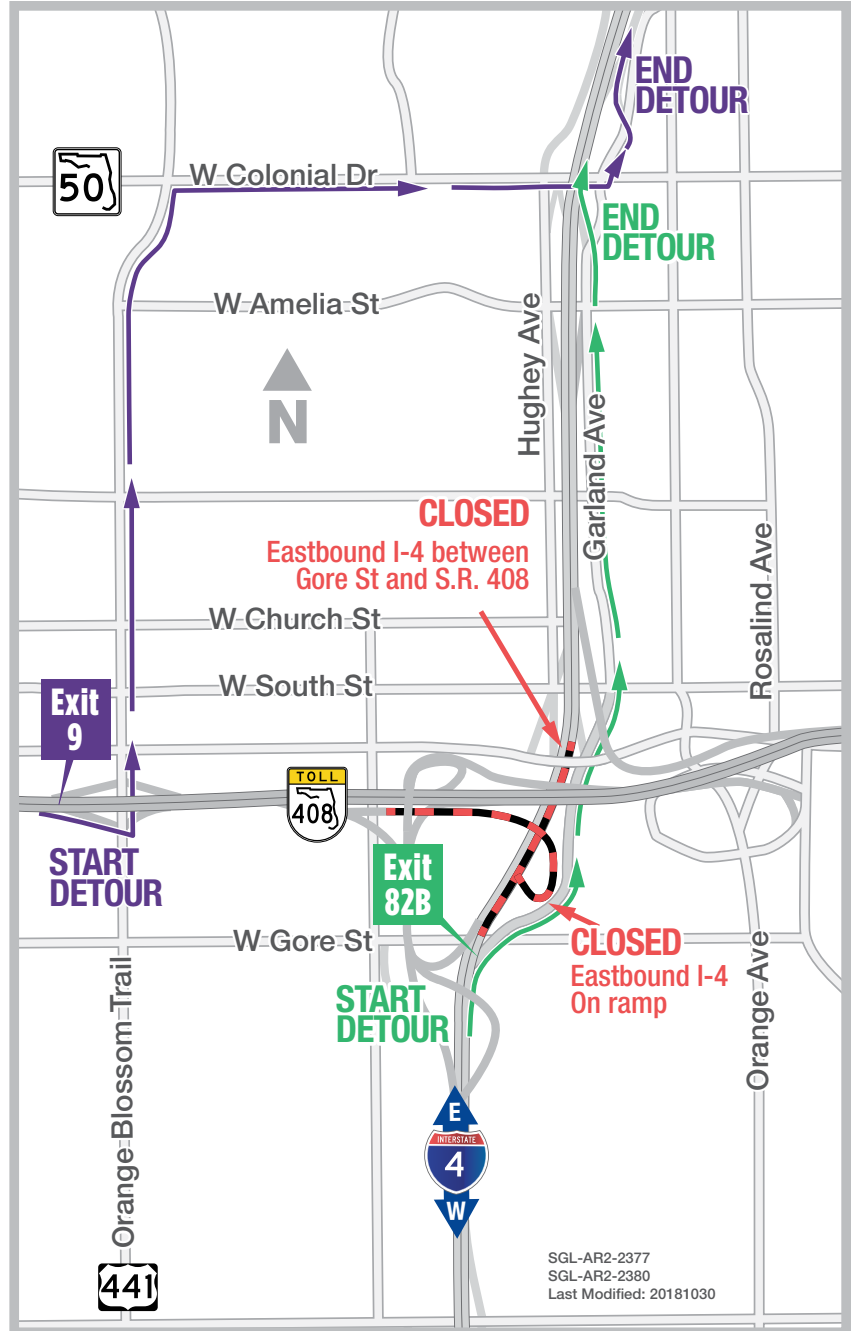

Sign up for I-4 Construction Updates and Alerts at I4Ultimate.com
 Learn about commuter options in Central Florida at reThinkYourCommute.com





BUILDING A BETTER I-4

Stay Informed:

- » Project Hotline: 844-ULT-INFO (858-4636)
- » Sign up for email and text alerts at fdot.tips/I4Alerts
- » Follow @i4Ultimate on Twitter
- » Subscribe to our monthly newsletter at fdot.tips/I4News

EASTBOUND & WESTBOUND I-4 THROUGH DOWNTOWN ORLANDO CLOSING NIGHT OF MARCH 22

NIGHTTIME CLOSURE OF EASTBOUND INTERSTATE 4 (I-4) BETWEEN GORE STREET AND STATE ROAD (S.R.) 408 AND WESTBOUND I-4 BETWEEN COLONIAL DRIVE AND S.R. 408

The Florida Department of Transportation is temporarily closing at night westbound I-4 between Colonial Drive and S.R. 408. The roadway will close at 11 p.m. on Friday, March 22 and will reopen by 5 a.m. the following morning. Law enforcement officers will be monitoring each signalized intersection on the detour route of Colonial Drive and Orange Blossom Trail (U.S. 17-92/441) to promote traffic flow. The westbound I-4 entrance ramps from Colonial Drive, Amelia Street and South Street also will close between 11 p.m. to 5 a.m. The westbound I-4 entrance ramps from Kaley Avenue and Gore Street will remain open during this closure. See reverse side for eastbound I-4 closure information and detour map. The closures are necessary for bridge work. Closures are dependent on weather and other conditions.

Traveling westbound on I-4:

- Exit westbound I-4 at Exit 84A to Colonial Drive
- Turn right onto Colonial Drive
- Turn left onto Orange Blossom Trail
- Follow signage to westbound I-4 on-ramp

Traveling eastbound or westbound on Colonial Drive to westbound I-4:

- Head westbound on Colonial Drive
- Turn left onto Orange Blossom Trail
- Follow signage to westbound I-4 on-ramp

Traveling westbound on South Street to westbound I-4:

- Turn left onto Parramore Avenue
- Turn left onto Gore Street
- Follow signage to westbound I-4 on-ramp

Closure subject to change. Construction progress, roadway conditions and weather may require schedule adjustments.

Please check i4ultimate.com/alertsmap for the most up-to-date information.

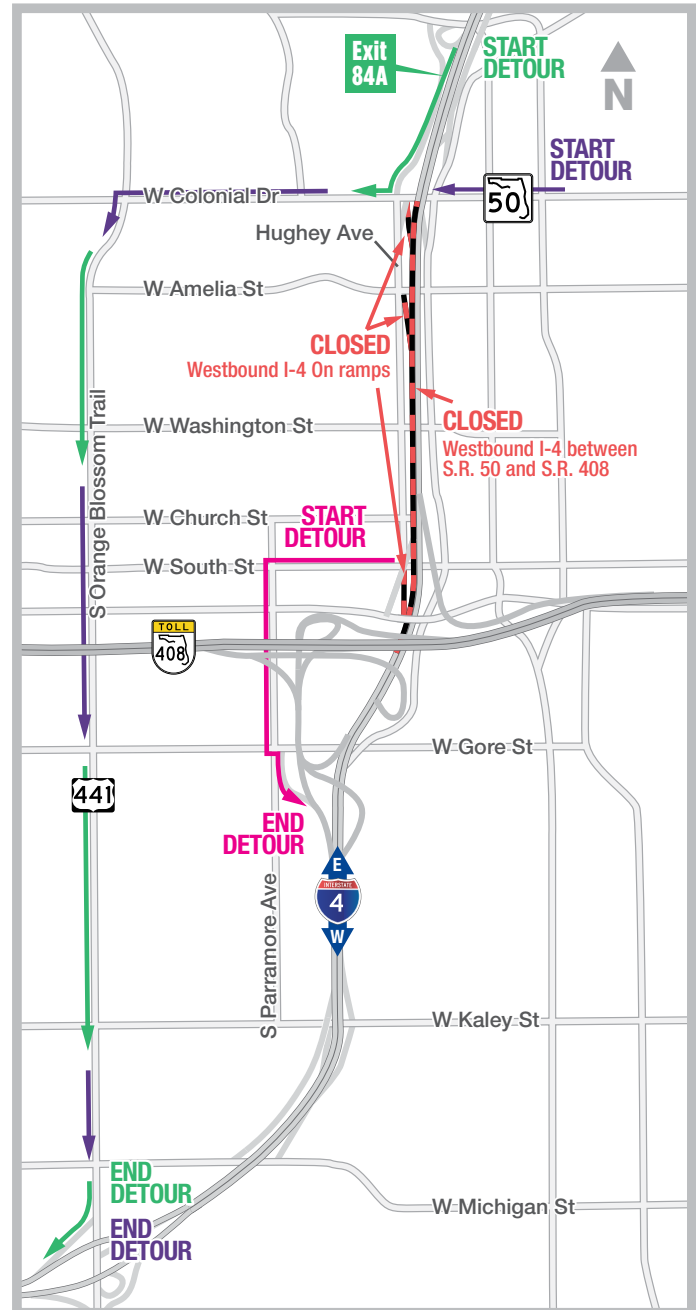

Sign up for I-4 Construction Updates and Alerts at I4Ultimate.com
Learn about commuter options in Central Florida at reThinkYourCommute.com

