



# BUILDING A BETTER I-4

### Stay Informed:

- » Project Hotline: 844-ULT-INFO (858-4636)
- » Sign up for email and text alerts at [I4Ultimate.com](http://I4Ultimate.com)
- » For real-time traffic conditions call 511, download Florida 511 mobile apps or visit [FL511.com](http://FL511.com)
- » Follow @i4ultimate on Twitter

## EASTBOUND I-4 NIGHTLY CLOSURES IN DOWNTOWN ORLANDO

EASTBOUND INTERSTATE 4 (I-4) IS CLOSING NIGHTLY UNDER STATE ROAD (S.R.) 408 FOR BRIDGE WORK.

THE CLOSURE IS SCHEDULED FOR 10 PM TO 5 AM ON AUGUST 12-15.

THE EASTBOUND S.R. 408 EXIT RAMP (EXIT 10B) TO EASTBOUND I-4 IS ALSO CLOSING NIGHTLY AUGUST 12-15.

The Florida Department of Transportation is closing eastbound I-4 during the hours of 10 p.m. to 5 a.m. on Friday, August 12, through Monday, August 15. The eastbound S.R. 408 exit ramp (Exit 10B) to eastbound I-4 is also closing from 10 p.m. to 5 a.m. on August 12 through August 15. These closures are necessary for bridge work on S.R. 408. Travelers should note the S.R. 50 eastbound on ramp to I-4 is also closed and is not a recommended alternative. For up to date information, sign up for advance construction alerts at [i4ultimate.com](http://i4ultimate.com).

See more details and download this handout at: [i4ultimate.com/i4closure](http://i4ultimate.com/i4closure)

### STARTING: Eastbound I-4

Begin detour by exiting eastbound I-4 at South Street (Exit 82B). At the South Street intersection at the end of the ramp, continue through the intersection onto Garland Avenue. Follow signs on Garland Avenue to eastbound I-4 entrance ramp. The eastbound I-4 entrance ramp from Garland Avenue is after the Amelia Street intersection.

### STARTING: Eastbound S.R. 408 to eastbound I-4

Begin detour by exiting S.R. 408 at Orange Blossom Trail (U.S. 17-92/441) (Exit 9). Continue on Orange Blossom Trail until the Colonial Drive (S.R. 50) intersection. Turn right on Colonial Drive. Follow signs on Colonial Drive to eastbound I-4 entrance ramp.

Closure subject to change. Construction progress, roadway conditions and weather may require schedule adjustments. Please check [i4ultimate.com/alertsmap](http://i4ultimate.com/alertsmap) for the most up-to-date information.

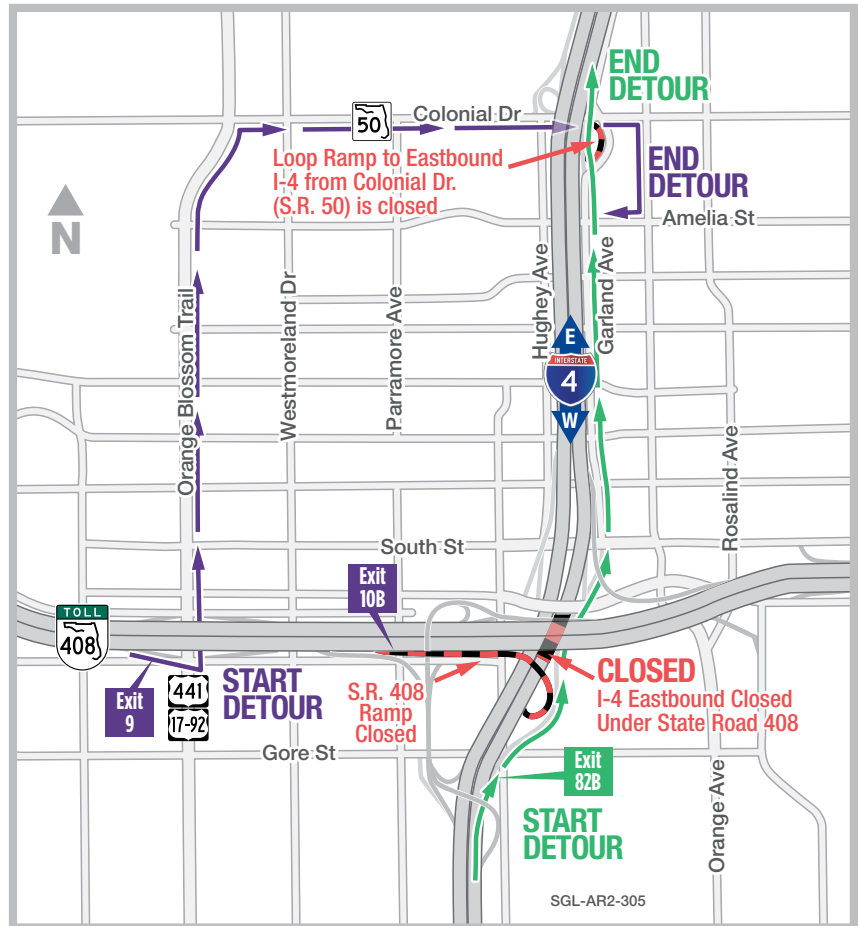

### PROJECT INFO

The \$2.3 billion I-4 Ultimate project is reconstructing 21 miles of interstate from west of Kirkman Road to east of State Road 434 in Longwood. For more information about I-4 Ultimate, contact David Parks, I-4 Ultimate Public Information Officer, at 844-ULT-INFO (844-858-4636) or [DavidParks@i4Ultimate.com](mailto:DavidParks@i4Ultimate.com).



Sign up for I-4 Construction Updates and Alerts at [I4Ultimate.com](http://I4Ultimate.com)  
Get real-time traffic and incident alerts at [FL511.com](http://FL511.com)

