



# BUILDING A BETTER I-4

## Stay Informed:

- » Project Hotline: 844-ULT-INFO (858-4636)
- » Sign up for email and text alerts at [fdot.tips/I4Alerts](https://fdot.tips/I4Alerts)
- » Follow @i4Ultimate on Twitter
- » Subscribe to our monthly newsletter at [fdot.tips/I4News](https://fdot.tips/I4News)

## MAJOR CHANGE TO EASTBOUND MAITLAND BOULEVARD (STATE ROAD 414) TO BEGIN AS SOON AS SEPTEMBER 8

Access to eastbound Interstate 4 (I-4) ONLY from two new on-ramps located just past the intersections of **A** Maitland Summit Boulevard and **B** just past Keller Road. See detailed circles on the map.

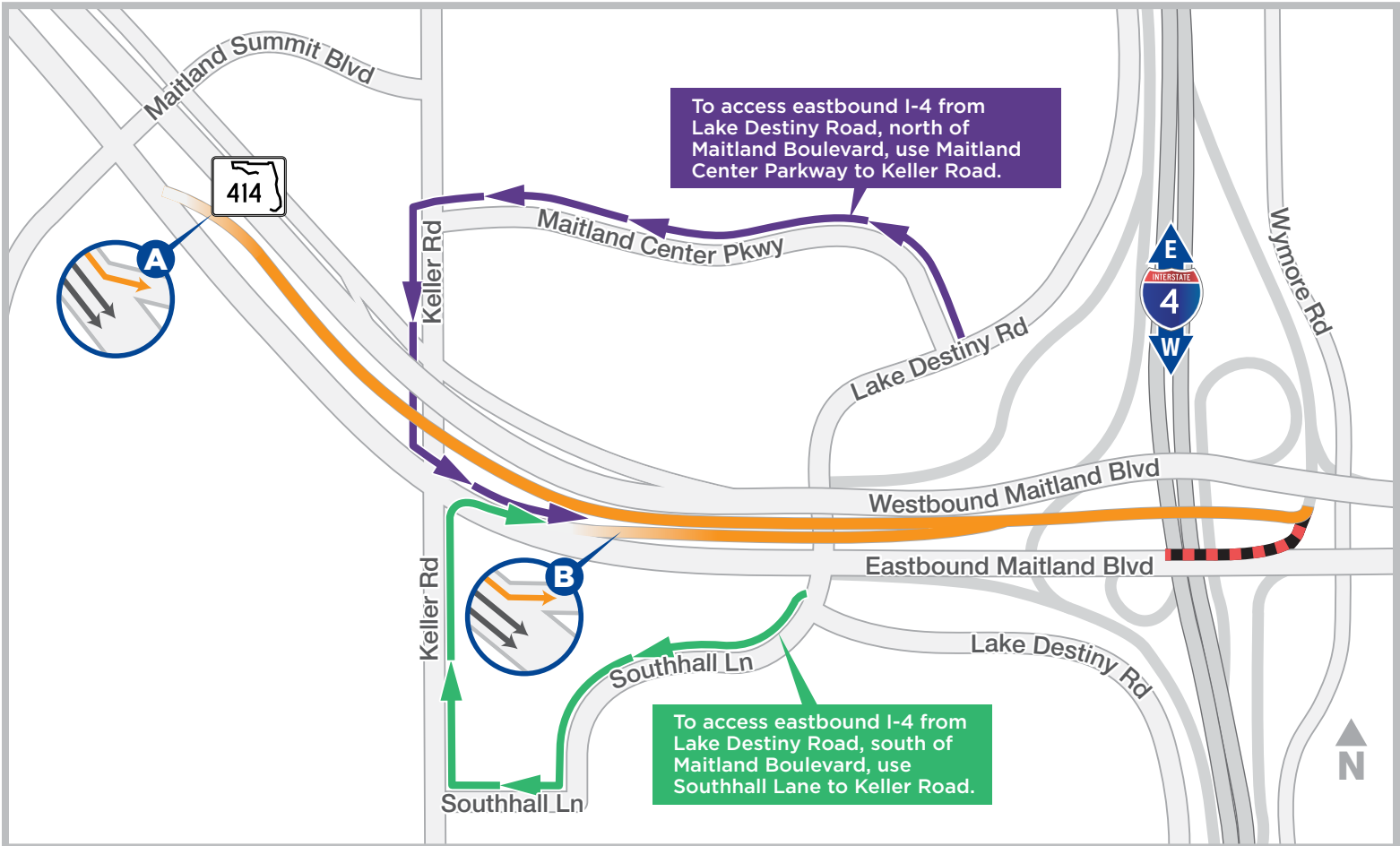

### BACKGROUND INFO

Temporary configuration to eastbound Maitland Boulevard is required to continue constructing the roadway's new elevated lanes and ramps at the I-4 interchange. A second major traffic shift on eastbound Maitland Boulevard is expected by mid-September. Traffic shift subject to change. Construction progress, roadway conditions and weather may require schedule adjustments. Visit [i4ultimate.com/alertsmap](https://i4ultimate.com/alertsmap) for most up-to-date information.

More info: [i4Ultimate.com/EB414](https://i4ultimate.com/EB414)



Sign up for I-4 Construction Updates and Alerts at [I4Ultimate.com](https://I4Ultimate.com)  
Learn about commuter options in Central Florida at [reThinkYourCommute.com](https://reThinkYourCommute.com)

