



# BUILDING A BETTER I-4

## Stay Informed:

- » Project Hotline: 844-ULT-INFO (858-4636)
- » Sign up for email and text alerts at [fdot.tips/I4Alerts](https://fdot.tips/I4Alerts)
- » Follow @i4Ultimate on Twitter
- » Subscribe to our monthly newsletter at [fdot.tips/I4News](https://fdot.tips/I4News)

## EB I-4 BETWEEN SOUTH ST. AND LEE RD. SHIFTING TO FINAL CONFIGURATION

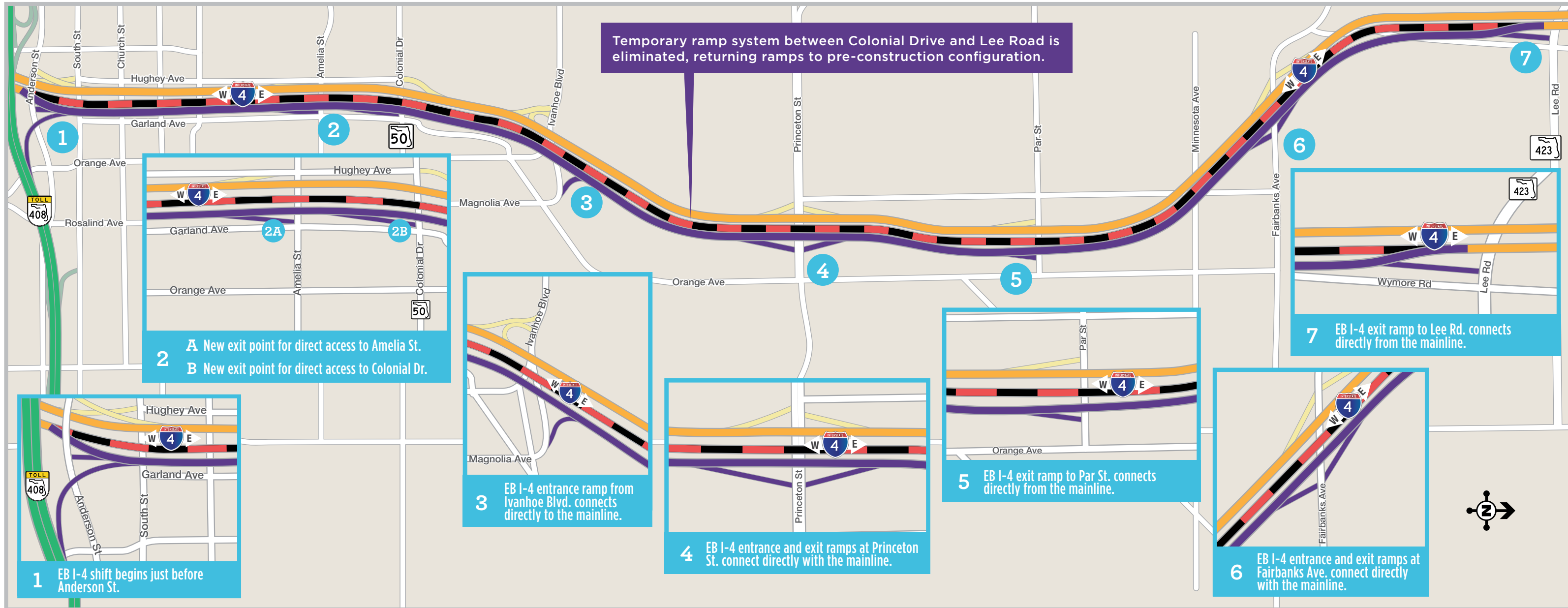

As soon as 5 a.m. the morning of Monday, June 24, the final configuration of eastbound I-4 between South Street and Lee Road (State Road 423) will open to motorists. The eastbound I-4 temporary ramp system between Colonial Drive (State Road 50) and Lee Road will be eliminated, returning ramps to pre-construction configuration. Motorists should anticipate additional capacity on the temporary ramp system over the weekend in preparation for the shift. With this shift, eight contiguous miles of eastbound I-4 will be set in their permanent configuration, marking significant completion on this part of the I-4 Ultimate project.

Two new exit ramps to Amelia Street and Colonial Drive will also open the morning of June 24, and the U-Turn from the Colonial Drive exit ramp under I-4 to southbound Hughey Avenue will be temporarily unavailable.

**PROJECT INFO**

The \$2.3 billion I-4 Ultimate project is reconstructing 21 miles of interstate from west of Kirkman Road to east of State Road 434 in Longwood. For more information about I-4 Ultimate, contact David Parks, I-4 Ultimate Community Outreach Specialist, at 844-ULT-INFO (844-858-4636) or [DavidParks@i4Ultimate.com](mailto:DavidParks@i4Ultimate.com).

Roadway shift subject to change. Construction progress, roadway conditions and weather may require schedule adjustments. Please check [i4ultimate.com/alertsmap](https://i4ultimate.com/alertsmap) for the most up-to-date information.

For more information about closures preceding the eastbound I-4 shift, please visit [I4Ultimate.com/EBI4](https://I4Ultimate.com/EBI4)