



BUILDING A BETTER I-4

Stay Informed:

- » Project Hotline: 844-ULT-INFO (858-4636)
- » Sign up for email and text alerts at fdot.tips/I4Alerts
- » Follow @i4Ultimate on Twitter
- » Subscribe to our monthly newsletter at fdot.tips/I4News

WESTBOUND S.R. 408 AT I-4 CLOSING EARLY MORNING OCTOBER 1

The Florida Department of Transportation is temporarily closing westbound State Road (S.R.) 408 at Interstate 4 (I-4) from 12 a.m. until 5 a.m. on Tuesday, October 1. The westbound S.R. 408 exit ramp to westbound I-4 will be closed simultaneously. The closure is necessary for bridge work.

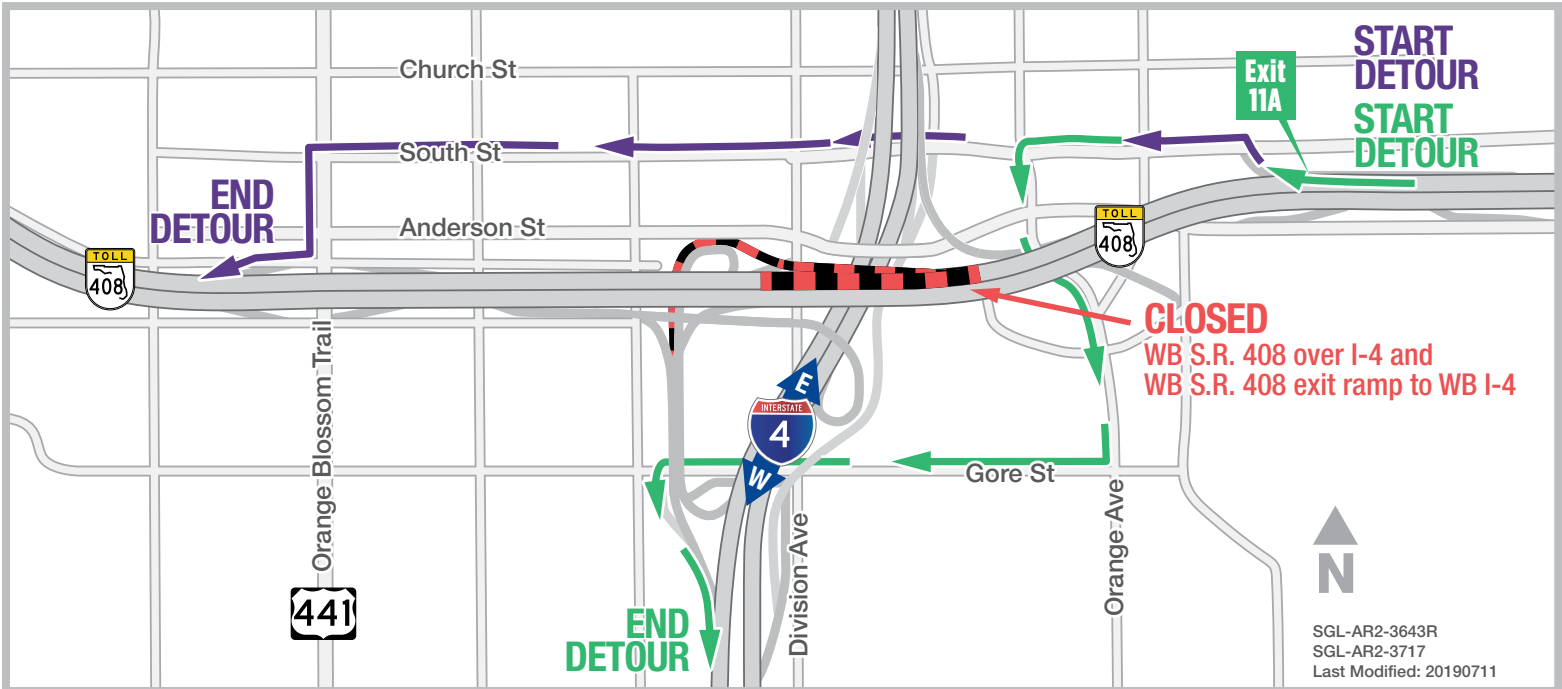

Traveling westbound on S.R. 408:

- Use Exit 11A to Rosalind Avenue
- Turn left onto South Street
- Turn left onto Orange Blossom Trail (U.S. 441-17/92)
- Follow signage to westbound S.R. 408

Traveling westbound on S.R. 408 to westbound I-4:

- Use Exit 11A to Rosalind Avenue
- Turn left onto South Street
- Turn left onto Orange Avenue
- Turn right onto Gore Street
- Follow signage to enter westbound I-4

PROJECT INFO

The \$2.3 billion I-4 Ultimate project is reconstructing 21 miles of interstate from west of Kirkman Road to east of State Road 434 in Longwood. For more information about I-4 Ultimate, contact David Parks, I-4 Ultimate Community Outreach Specialist, at 844-ULT-INFO (844-858-4636) or DavidParks@i4Ultimate.com.

Closure subject to change. Construction progress, roadway conditions and weather may require schedule adjustments. Please check i4ultimate.com/alertsmap for the most up-to-date information.



Sign up for I-4 Construction Updates and Alerts at I4Ultimate.com
Learn about commuter options in Central Florida at reThinkYourCommute.com

