



BUILDING A BETTER I-4

Stay Informed:

- » Project Hotline: 844-ULT-INFO (858-4636)
- » Sign up for email and text alerts at fdot.tips/I4Alerts
- » Follow @i4Ultimate on Twitter
- » Subscribe to our monthly newsletter at fdot.tips/I4News

TEMPORARY CONFIGURATION OF THE S.R. 436 AND I-4 INTERCHANGE

As soon as August 24, 2019, the State Road (S.R.) 436 interchange is undergoing a major temporary traffic shift providing work zones for crews to demolish the old S.R. 436 bridge over I-4 and continue construction on the new bridge. New traffic patterns will be introduced as part of this transformation, and motorists will use newly constructed bridge decks north and south of the old lanes. Both bridges will accommodate traffic in both directions. This interim configuration is expected to last for up to one year.

For more informational resources, including an animation detailing the new traffic patterns and the final interchange configuration, please visit i4ultimate.com/436.

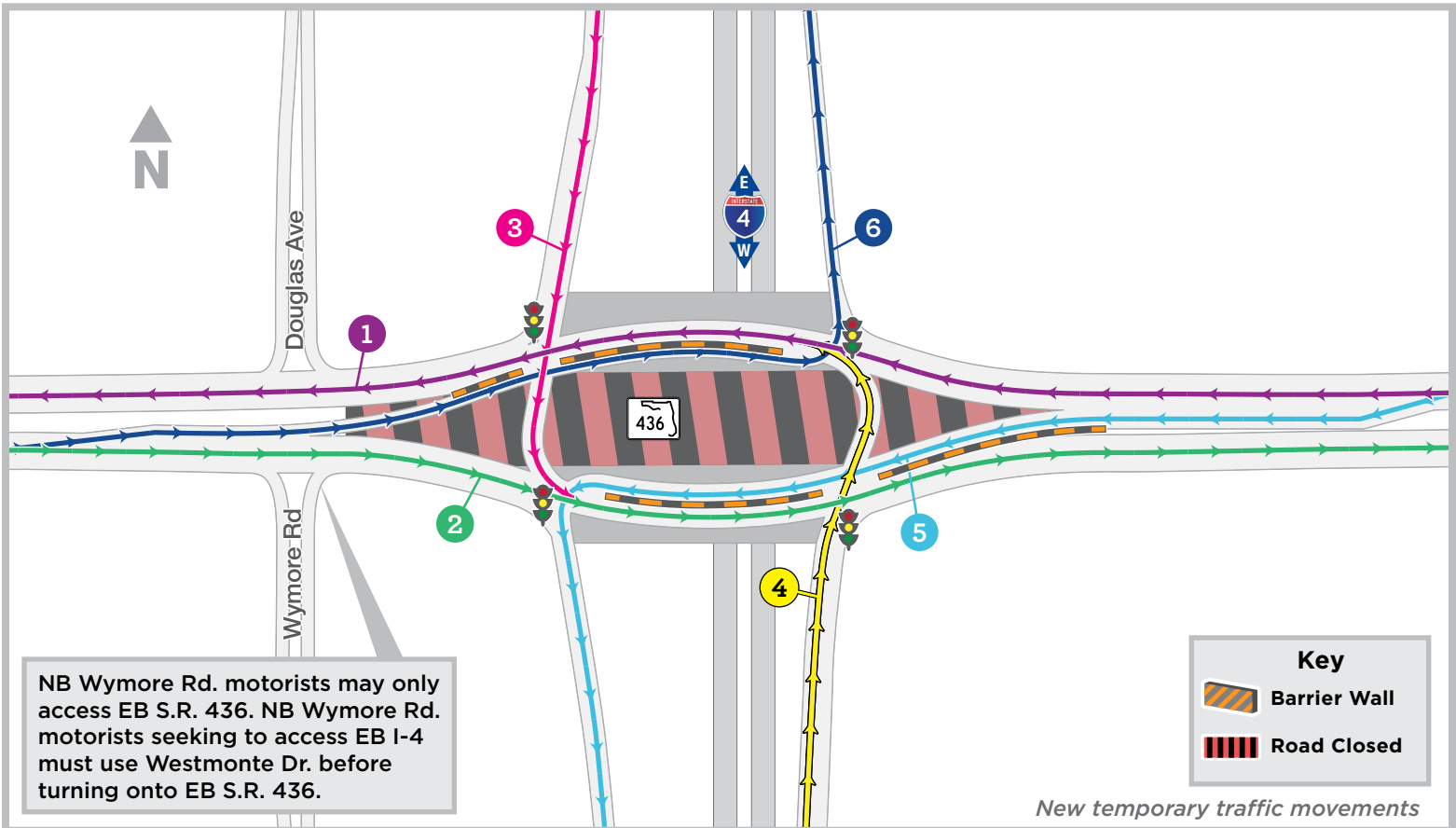

- | | |
|--|--|
| 1 Westbound S.R. 436 through traffic follows new alignment along north bridge. | 4 Eastbound I-4 motorists exiting to westbound S.R. 436 will cross over eastbound S.R. 436 onto the north bridge. |
| 2 Eastbound S.R. 436 through traffic follows new alignment along south bridge. | 5 Westbound S.R. 436 motorists entering westbound I-4 will use the south bridge. |
| 3 Westbound I-4 motorists exiting to eastbound S.R. 436 will cross over westbound S.R. 436 onto the south bridge. | 6 Eastbound S.R. 436 motorists entering eastbound I-4 will use the north bridge. |



Sign up for I-4 Construction Updates and Alerts at I4Ultimate.com

Learn about design and construction on the next 40 miles of I-4 at I4Beyond.com