



BUILDING A BETTER I-4

Stay Informed:

- » Project Hotline: 844-ULT-INFO (858-4636)
- » Sign up for email and text alerts at fdot.tips/I4Alerts
- » Follow @i4Ultimate on Twitter
- » Subscribe to our monthly newsletter at fdot.tips/I4News

SOUTHBOUND KIRKMAN ROAD OVER I-4 CLOSING MORNING OF OCTOBER 15

CLOSURE SCHEDULED TO BEGIN AS SOON AS MIDNIGHT AND END AT 5 AM

The Florida Department of Transportation (FDOT) is temporarily closing southbound Kirkman Road (State Road 435) from Major Boulevard to International Drive and the westbound Interstate 4 (I-4) exit to southbound Kirkman Road as soon as midnight on Tuesday, October 15, and reopening it at 5 a.m. The closure is necessary for lighting work.

Traveling on southbound Kirkman Road:

- Turn left onto Major Boulevard
- Turn right onto Grand National Drive
- Turn right onto International Drive
- Turn left onto Kirkman Road

Exiting westbound I-4 to southbound Kirkman Road:

- Take the exit to northbound Kirkman Road
- Turn right onto Major Boulevard
- Turn right onto Grand National Drive
- Turn right onto International Drive
- Turn left onto Kirkman Road

PROJECT INFO

The \$2.3 billion I-4 Ultimate project is reconstructing 21 miles of interstate from west of Kirkman Road to east of State Road 434 in Longwood. For more information about I-4 Ultimate, contact David Parks, I-4 Ultimate Community Outreach Specialist, at 844-ULT-INFO (844-858-4636) or DavidParks@i4Ultimate.com.

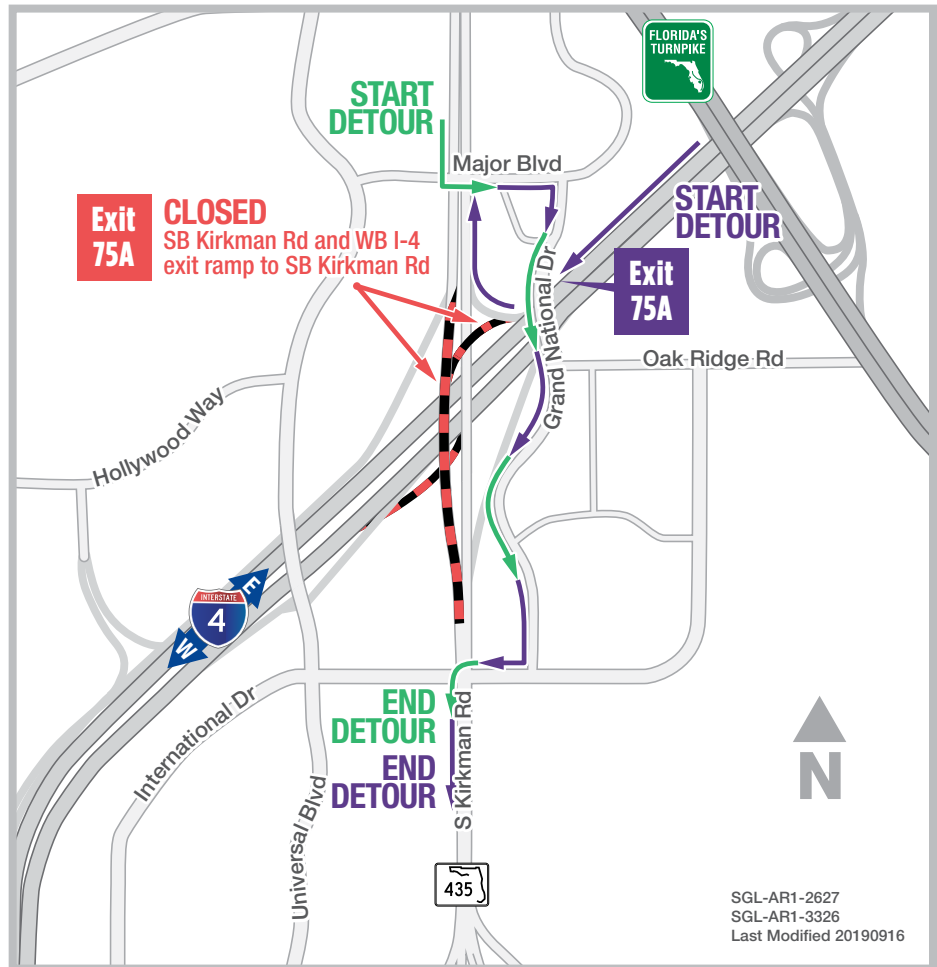

Closure subject to change. Construction progress, roadway conditions and weather may require schedule adjustments. Please check i4ultimate.com/alertsmap for the most up-to-date information.



Sign up for I-4 Construction Updates and Alerts at I4Ultimate.com

Learn about design and construction on the next 40 miles of I-4 at I4Beyond.com