



BUILDING A BETTER I-4

Stay Informed:

- » Project Hotline: 844-ULT-INFO (858-4636)
- » Sign up for email and text alerts at fdot.tips/I4Alerts
- » Follow @i4Ultimate on Twitter
- » Subscribe to our monthly newsletter at fdot.tips/I4News

WESTBOUND S.R. 408 AT I-4 CLOSING MORNING OF JANUARY 11

The Florida Department of Transportation (FDOT) is temporarily closing westbound State Road (S.R.) 408 at Interstate 4 (I-4) from 12 a.m. – 7 a.m. Saturday, January 11. Also closing at this time are the westbound S.R. 408 exit ramp to westbound I-4, the eastbound and westbound I-4 ramps to S.R. 408 and the entrance ramp to S.R. 408 from Division Avenue. The closures are necessary for sign installation.

Traveling westbound I-4 to S.R. 408:

- Take the exit to Anderson Street (Exit 82B)
 - Turn right onto Anderson Street
 - Turn right onto Division Avenue
 - Turn left onto South Street
 - Turn left onto Orange Blossom Trail (U.S. 441/17/92)
 - Follow signs to westbound S.R. 408
- Or
- Turn left on Anderson Street
 - Follow signs to eastbound S.R. 408

Traveling eastbound I-4 to S.R. 408:

- Take the exit to South Street (Exit 82B)
 - Turn left onto South Street
 - Follow signs to westbound S.R. 408
- Or
- Turn right on South Street
 - Turn right on Orange Avenue
 - Turn left on Anderson Street
 - Follow signs to eastbound S.R. 408

Traveling westbound on S.R. 408:

- Take the exit to Rosalind Avenue (Exit 11A)
- Turn left onto South Street
- Turn left onto Orange Blossom Trail
- Follow signage to westbound S.R. 408

Traveling on westbound S.R. 408 to eastbound I-4:

- Take the exit to Rosalind Avenue (Exit 11A)
- Turn left onto South Street
- Turn right onto Garland Avenue
- Follow signs to eastbound I-4

Traveling on westbound S.R. 408 to westbound I-4:

- Use the exit to Rosalind Avenue (11A)
- Turn left onto South Street
- Turn left onto Orange Avenue
- Turn right onto Gore Street
- Follow signs to westbound I-4

Entering WB S.R. 408 from Division Avenue:

- Continue south on Division Avenue
- Turn left onto Gore Street
- Turn left onto Orange Avenue
- Turn left onto South Street
- Turn left onto Orange Blossom Trail
- Follow signs to westbound S.R. 408

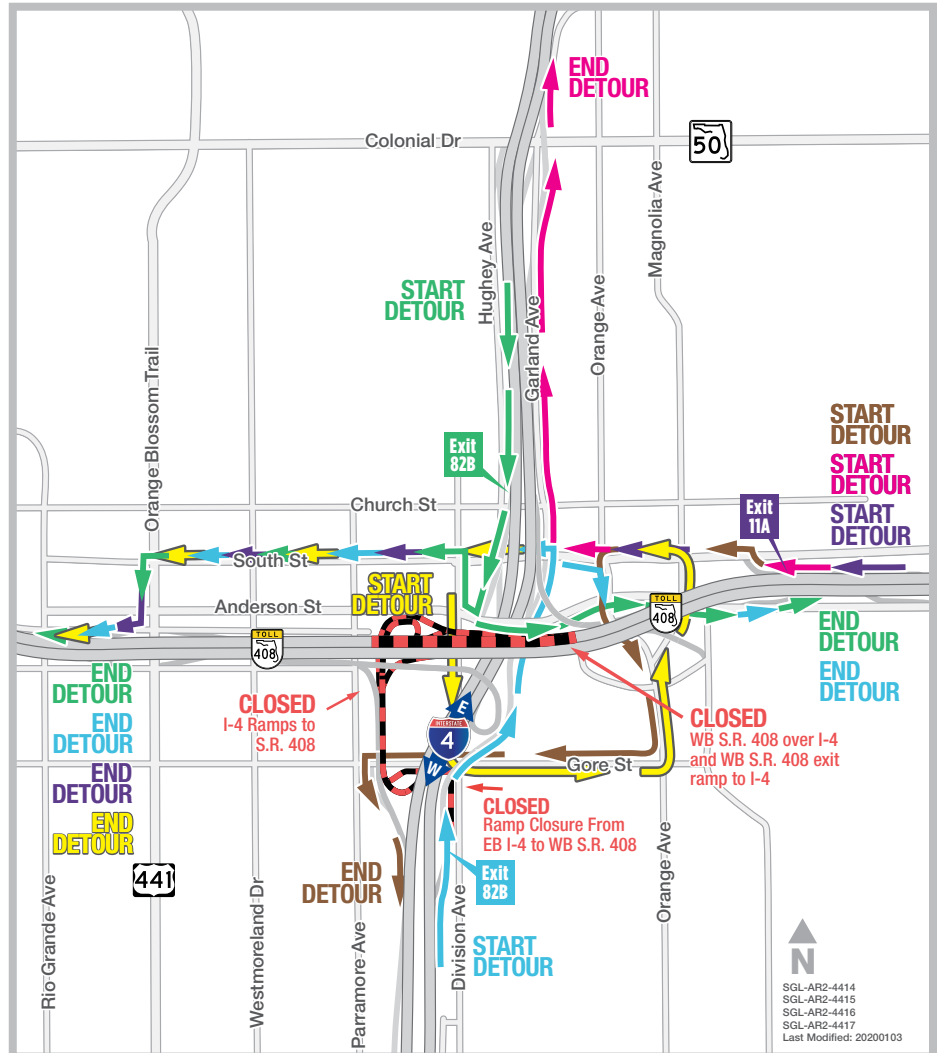

Sign up for I-4 Construction Updates and Alerts at I4Ultimate.com

Learn about design and construction on the next 40 miles of I-4 at I4Beyond.com