



BUILDING A BETTER I-4

Stay Informed:

- » Project Hotline: 844-ULT-INFO (858-4636)
- » Sign up for email and text alerts at fdot.tips/I4Alerts
- » Follow @i4Ultimate on Twitter
- » Subscribe to our monthly newsletter at fdot.tips/I4News

NEW WESTBOUND I-4 ENTRANCE RAMP FROM WESTBOUND STATE ROAD 434 OPENING

TRAFFIC TO FREE FLOW ONTO I-4

A new entrance ramp from westbound State Road (S.R.) 434 to westbound Interstate 4 (I-4) will open as soon as Saturday, April 4. The new ramp allows drivers to enter I-4 without a traffic signal, improving traffic flow on S.R. 434. Motorists will need to be in the right lane as they pass under I-4 to enter the single lane ramp from the right side of S.R. 434. Traffic will loop around to the right, crossing over S.R. 434 on a new bridge before joining westbound I-4 traffic.

The left turn lanes that begin on the east side of I-4 will close when the new ramp opens.

Please remember to stay alert when driving through the work zone and pay close attention to roadway signs and messages. The westbound I-4 entrance ramp from S.R. 434 will close overnight to facilitate the ramp opening. See page 2 for more information. See page 3 for information about final improvements to the interchange.



PROJECT INFO

The \$2.3 billion I-4 Ultimate project is reconstructing 21 miles of interstate from west of Kirkman Road to east of State Road 434 in Longwood. For more information about I-4 Ultimate, contact David Parks, I-4 Ultimate Community Outreach Specialist, at 844-ULT-INFO (844-858-4636) or DavidParks@i4Ultimate.com.

Shift subject to change. Construction progress, roadway conditions and weather may require schedule adjustments. Please check i4ultimate.com/alertsmap for the most up-to-date information.



Sign up for I-4 Construction Updates and Alerts at I4Ultimate.com

Learn about design and construction on the next 40 miles of I-4 at I4Beyond.com



BUILDING A BETTER I-4

Stay Informed:

- » Project Hotline: 844-ULT-INFO (858-4636)
- » Sign up for email and text alerts at fdot.tips/I4Alerts
- » Follow @i4Ultimate on Twitter
- » Subscribe to our monthly newsletter at fdot.tips/I4News

WESTBOUND I-4 ENTRANCE RAMP FROM STATE ROAD 434 CLOSING OVERNIGHT

CLOSURE TO PREPARE FOR NEW WESTBOUND I-4 LOOP RAMP

The Florida Department of Transportation (FDOT) is temporarily closing the westbound Interstate 4 (I-4) entrance ramp from State Road (S.R.) 434.

The closure is scheduled to occur April 3, 8 p.m., and reopen the next morning by 6 a.m.

The closure is necessary for workers to safely complete construction of the new westbound I-4 entrance loop ramp from westbound S.R. 434. See page 1 for more information about the new westbound I-4 entrance ramp from westbound S.R. 434. See page 3 for information about final improvements to the interchange.

Traveling eastbound S.R. 434:

- Turn right onto Ronald Reagan Boulevard
- Turn right onto S.R. 436
- Follow signage to westbound I-4

Traveling westbound S.R. 434:

- Turn left onto S.R. 436
- Follow signage to westbound I-4

PROJECT INFO

The \$2.3 billion I-4 Ultimate project is reconstructing 21 miles of interstate from west of Kirkman Road to east of State Road 434 in Longwood. For more information about I-4 Ultimate, contact David Parks, I-4 Ultimate Community Outreach Specialist, at 844-ULT-INFO (844-858-4636) or DavidParks@i4Ultimate.com.

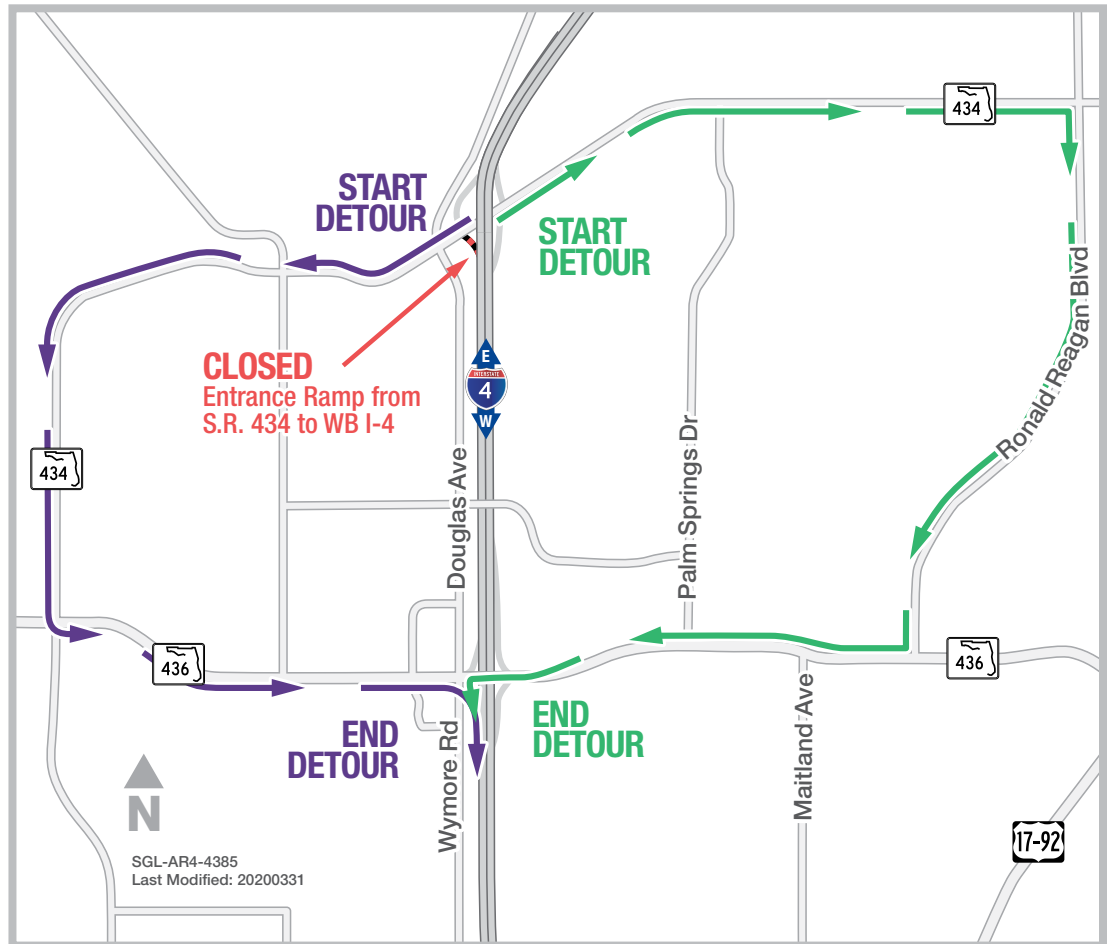

Closure subject to change. Construction progress, roadway conditions and weather may require schedule adjustments. Please check i4ultimate.com/alertsmap for the most up-to-date information.



Sign up for I-4 Construction Updates and Alerts at I4Ultimate.com

Learn about design and construction on the next 40 miles of I-4 at I4Beyond.com



BUILDING A BETTER I-4

Stay Informed:

- » Project Hotline: 844-ULT-INFO (858-4636)
- » Sign up for email and text alerts at fdot.tips/I4Alerts
- » Follow @i4Ultimate on Twitter
- » View our weekly construction update video at fdot.tips/I4Video
- » Subscribe to our monthly newsletter at fdot.tips/I4News

REDESIGNED I-4 INTERCHANGE IMPROVEMENTS AT STATE ROAD 434

Once the I-4 Ultimate construction is complete, the redesigned State Road (S.R.) 434 interchange will accommodate a greater volume of motorists.

1

Relocating the westbound I-4 exit ramp to S.R. 434. The new ramp will have two lanes exiting I-4 and four lanes at the intersection with S.R. 434, adding capacity.

2

Separating the westbound I-4 ramp from westbound S.R. 434 to a new loop ramp allows traffic to free flow onto I-4 without going through a traffic signal. The new loop ramp also will have an auxiliary lane on I-4 for merging.

3

Adding additional capacity on S.R. 434 underneath I-4

4

Adding a second right turn lane from the eastbound I-4 exit ramp to S.R. 434

5

Realigning and lengthening the westbound I-4 entrance ramp from eastbound S.R. 434

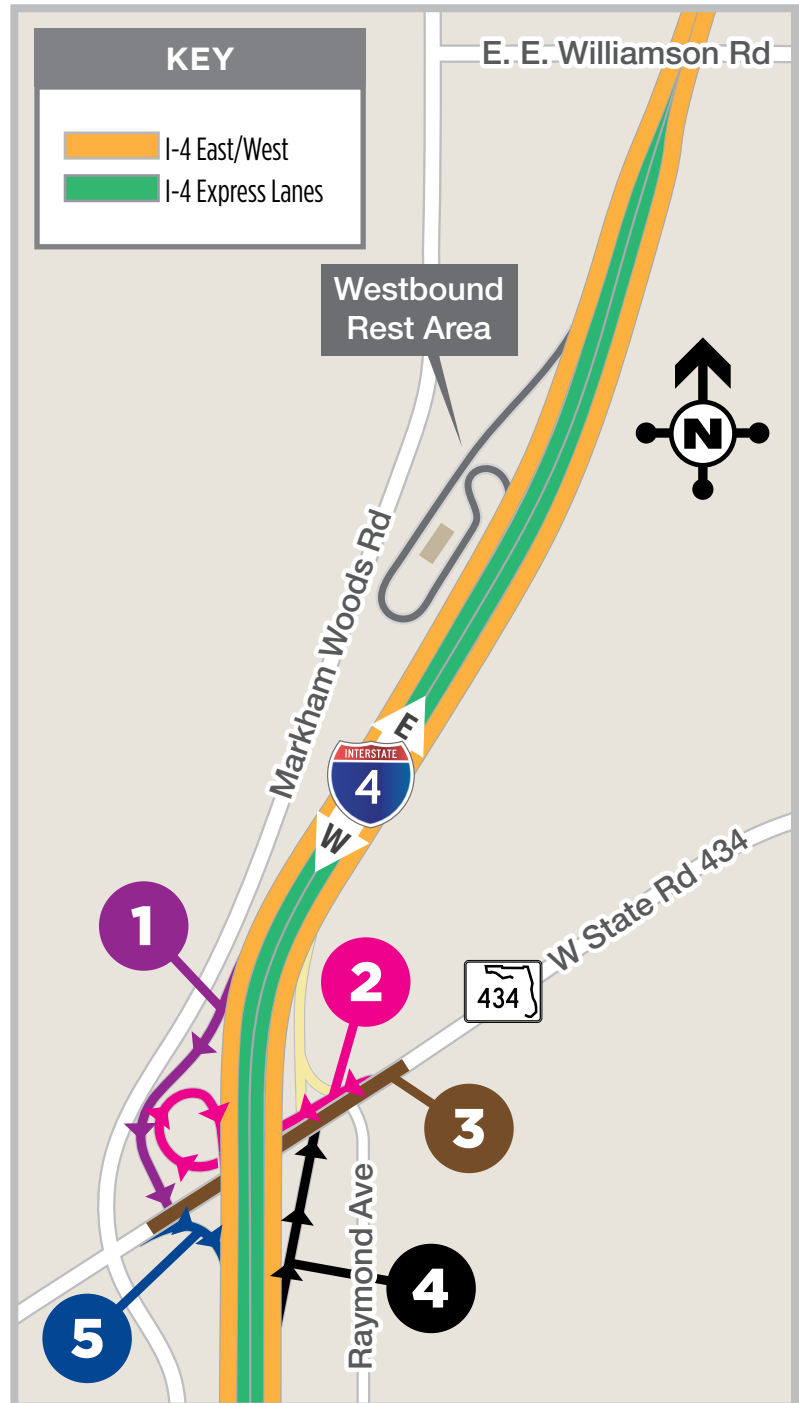

Sign up for I-4 Construction Updates and Alerts at I4Ultimate.com
Learn about commuter options in Central Florida at reThinkYourCommute.com

