



BUILDING A BETTER I-4

Stay Informed:

- » Project Hotline: 844-ULT-INFO (858-4636)
- » Sign up for email and text alerts at fdot.tips/I4Alerts
- » Follow @i4Ultimate on Twitter
- » Subscribe to our monthly newsletter at fdot.tips/I4News

NEW EB I-4 EXIT TO SANDSPUR ROAD OPENING JUNE 18

The Florida Department of Transportation (FDOT) will open a new eastbound interstate 4 (I-4) exit ramp to Sandspur Road as soon as Thursday, June 18.

The ramp is combined with the eastbound I-4 Exit 90 ramps to westbound Maitland Boulevard (State Road 414) (Exit 90B) and eastbound Maitland Boulevard (Exit 90A). The new ramp to Sandspur Road splits from the eastbound Maitland Boulevard ramp.

The new ramp is the final step to putting eastbound I-4 Exit 90 in its final configuration.

To facilitate the new ramp, FDOT will close the eastbound I-4 exit to eastbound Maitland Boulevard overnight. Please see reverse for more information.

Motorists are advised to maintain a safe speed when driving through the work zone.

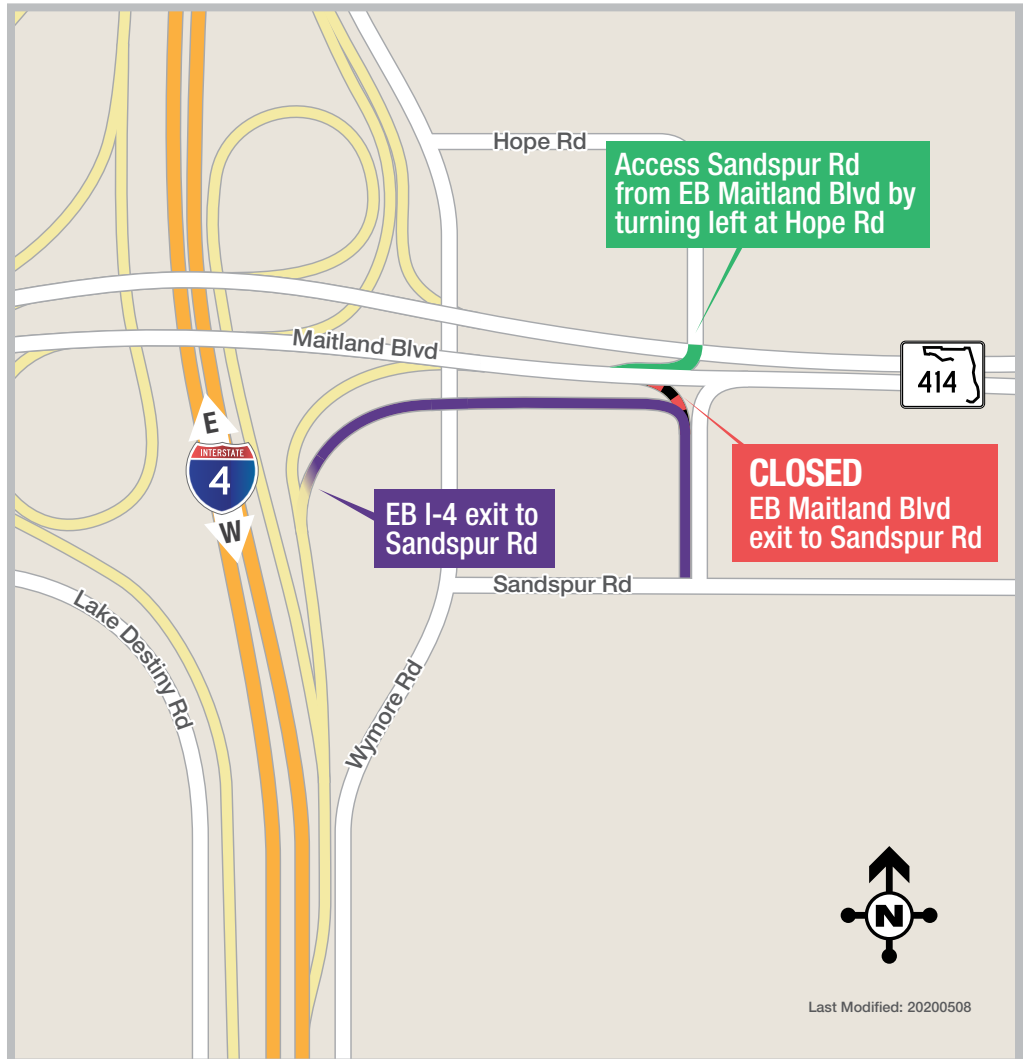

PROJECT INFO

The \$2.3 billion I-4 Ultimate project is reconstructing 21 miles of interstate from west of Kirkman Road to east of State Road 434 in Longwood. For more information about I-4 Ultimate, contact David Parks, I-4 Ultimate Community Outreach Specialist, at 844-ULT-INFO (844-858-4636) or DavidParks@i4Ultimate.com.

Shift subject to change. Construction progress, roadway conditions and weather may require schedule adjustments. Please check i4ultimate.com/alertsmap for the most up-to-date information.



Sign up for I-4 Construction Updates and Alerts at I4Ultimate.com

Learn about design and construction on the next 40 miles of I-4 at I4Beyond.com



BUILDING A BETTER I-4

Stay Informed:

- » Project Hotline: 844-ULT-INFO (858-4636)
- » Sign up for email and text alerts at fdot.tips/I4Alerts
- » Follow @i4Ultimate on Twitter
- » Subscribe to our monthly newsletter at fdot.tips/I4News

EB I-4 EXIT RAMP TO EB MAITLAND BOULEVARD CLOSES OVERNIGHT

The Florida Department of Transportation (FDOT) is temporarily closing the eastbound Interstate 4 (I-4) exit ramp to eastbound Maitland Boulevard (State Road 414) for one night.

The closure is scheduled to occur Wednesday, June 17, at 8 p.m. and reopen the following morning.

The closure is necessary to facilitate a new exit ramp opening, which leads to Sandspur Road. Please see reverse side for more information.

Motorists are advised to maintain a safe speed when driving through the work zone.

Traveling Eastbound I-4:

- Take Exit 92 to State Road 436
- Turn left onto State Road 436
- Turn left onto State Road 434
- Follow signage to eastbound Maitland Boulevard

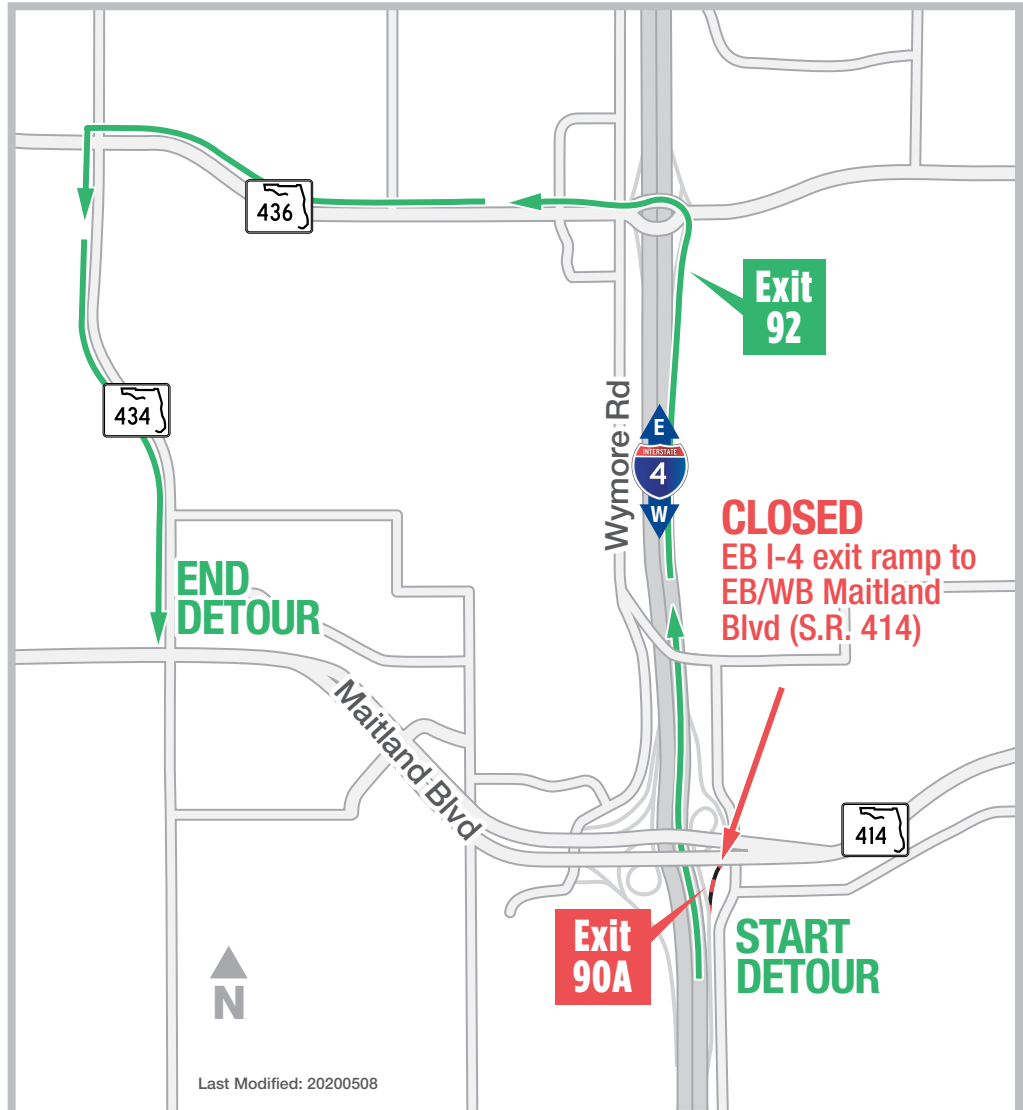

PROJECT INFO

The \$2.3 billion I-4 Ultimate project is reconstructing 21 miles of interstate from west of Kirkman Road to east of State Road 434 in Longwood. For more information about I-4 Ultimate, contact David Parks, I-4 Ultimate Community Outreach Specialist, at 844-ULT-INFO (844-858-4636) or DavidParks@i4Ultimate.com.

Closure subject to change. Construction progress, roadway conditions and weather may require schedule adjustments. Please check i4ultimate.com/alertsmap for the most up-to-date information.



Sign up for I-4 Construction Updates and Alerts at I4Ultimate.com

Learn about design and construction on the next 40 miles of I-4 at I4Beyond.com