



BUILDING A BETTER I-4

Stay Informed:

- » Project Hotline: 844-ULT-INFO (858-4636)
- » Sign up for email and text alerts at fdot.tips/I4Alerts
- » Follow @i4Ultimate on Twitter
- » Subscribe to our monthly newsletter at fdot.tips/I4News

WESTBOUND I-4 ENTRANCE FROM ORANGE BLOSSOM TRAIL CLOSING

TRUCKS DETOURED VIA COLONIAL DRIVE (STATE ROAD 50), JOHN YOUNG PARKWAY, AND KALEY AVENUE

The Florida Department of Transportation (FDOT) is closing the westbound Interstate 4 (I-4) entrance ramp from southbound Orange Blossom Trail (U.S. 441/17-92). The continuous closure is scheduled to begin as soon as 10 p.m. Tuesday, July 7, and continue through August. The continuous closure is necessary to rebuild a new entrance ramp.

Trucks will follow Orange Blossom Trail to Colonial Drive (State Road 50), John Young Parkway, and Kaley Avenue to enter I-4.

Accessing westbound I-4 from northbound Orange Blossom Trail:

- Continue north on Orange Blossom Trail
- Turn left onto Colonial Drive
- Turn left onto John Young Parkway
- Follow signs to westbound I-4

Accessing westbound I-4 from southbound Orange Blossom Trail:

- Turn right onto Colonial Drive
- Turn left onto John Young Parkway
- Follow signs to westbound I-4

Accessing westbound I-4 from northbound Orange Blossom Trail:

- Enter the eastbound I-4 ramp system from northbound Orange Blossom Trail
- Use Exit 81 to Kaley Avenue
- Use the U-turn under I-4
- Follow signs to westbound I-4 from Kaley Avenue

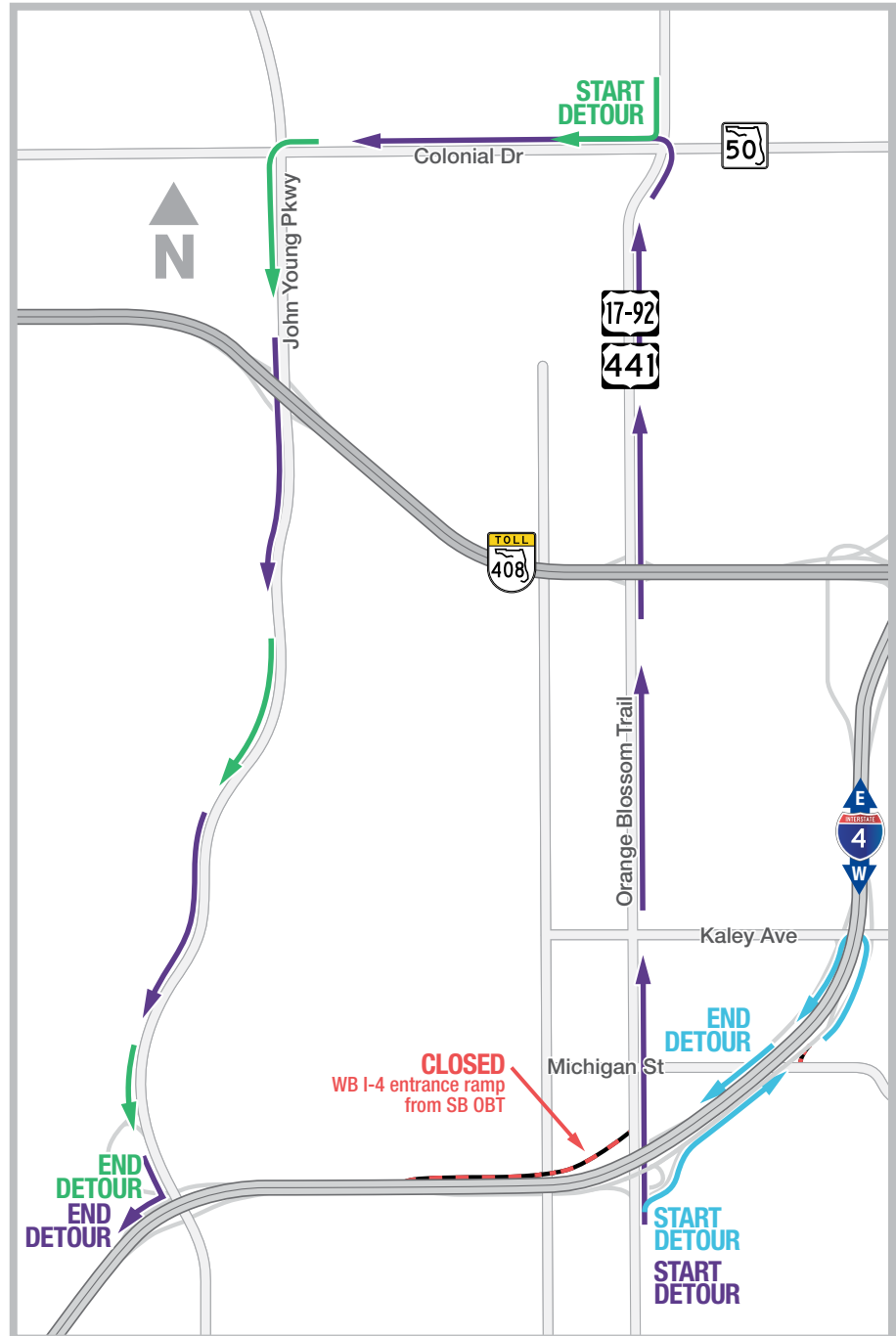

Sign up for I-4 Construction Updates and Alerts at I4Ultimate.com

Learn about design and construction on the next 40 miles of I-4 at I4Beyond.com