



# BUILDING A BETTER I-4

## Stay Informed:

- » Project Hotline: 844-ULT-INFO (858-4636)
- » Sign up for email and text alerts at [fdot.tips/I4Alerts](https://fdot.tips/I4Alerts)
- » Follow @i4Ultimate on Twitter
- » Subscribe to our monthly newsletter at [fdot.tips/I4News](https://fdot.tips/I4News)

## WEST SIDE DETOUR ROUTES FOR STATE ROAD 434 UNDER I-4 CLOSES FOR ONE NIGHT

The Florida Department of Transportation (FDOT) is temporarily closing State Road (S.R.) 434 under Interstate 4 (I-4) for one night, and the eastbound I-4 entrance ramp from S.R. 434, the westbound I-4 entrance ramp from westbound S.R. 436 and the westbound I-4 exit ramp to S.R. 434 for two nights.

S.R. 434 under I-4 will close Thursday, November 19 between 9 p.m. and 5 a.m. The eastbound I-4 entrance ramps from S.R. 434 and the westbound I-4 exit ramps to S.R. 434 will both close nightly between 10 p.m. and 6 a.m. from November 19-21.

Please see reverse side for detour routes for motorists on the east side of the I-4 and S.R. 434 interchange.

### Traveling westbound on S.R. 434 to eastbound I-4:

- Turn left onto Montgomery Road
- Turn left onto S.R. 436
- Follow signage to eastbound I-4

### Traveling eastbound on S.R. 434 (west of Montgomery Road):

- Turn right onto Montgomery Road
- Turn left onto S.R. 436
- Follow Signage to eastbound I-4
- Exit eastbound I-4 to S.R. 434 (Exit 94)

### Traveling westbound on S.R. 434 (east of Montgomery Road):

- Turn left onto Montgomery Road
- Turn left on S.R. 436
- Follow signage to eastbound I-4
- Exit eastbound I-4 to S.R. 434 (Exit 94)

Or

- Continue west on S.R. 434
- Turn left onto S.R. 436
- Follow signage to eastbound I-4
- Exit eastbound I-4 to S.R. 434 (Exit 94)

### Traveling westbound I-4 to S.R. 434:

- Continue on westbound I-4 to S.R. 436 (Exit 92)
- Turn right onto S.R. 436
- Continue to S.R. 434

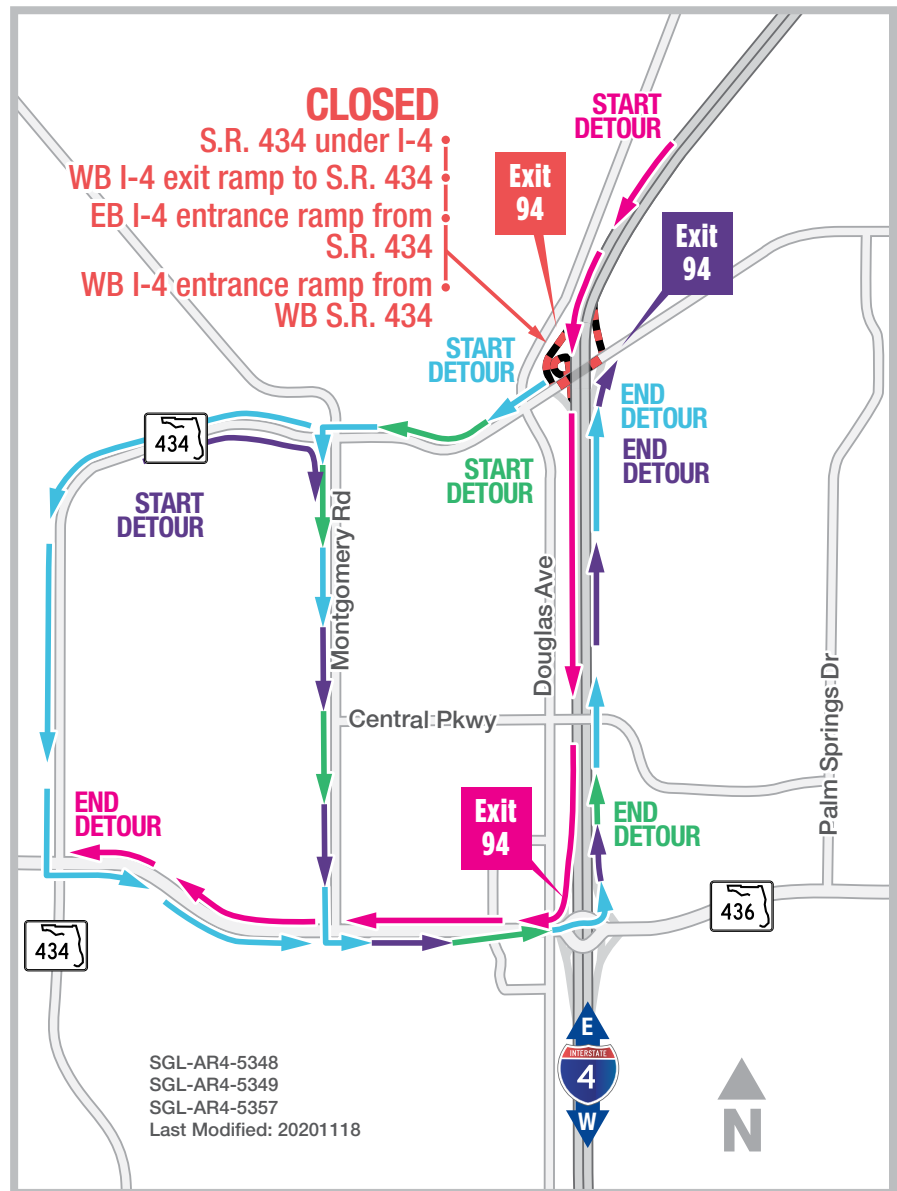

Sign up for I-4 Construction Updates and Alerts at [I4Ultimate.com](https://I4Ultimate.com)

Learn about design and construction on the next 40 miles of I-4 at [I4Beyond.com](https://I4Beyond.com)



# BUILDING A BETTER I-4

## Stay Informed:

- » Project Hotline: 844-ULT-INFO (858-4636)
- » Sign up for email and text alerts at [fdot.tips/I4Alerts](https://fdot.tips/I4Alerts)
- » Follow @i4Ultimate on Twitter
- » Subscribe to our monthly newsletter at [fdot.tips/I4News](https://fdot.tips/I4News)

## EAST SIDE DETOUR ROUTES FOR STATE ROAD 434 UNDER I-4 CLOSES FOR ONE NIGHT

The Florida Department of Transportation (FDOT) is temporarily closing State Road (S.R.) 434 under Interstate 4 (I-4) for one night, and the eastbound I-4 entrance ramp from S.R. 434, the westbound I-4 entrance ramp from westbound S.R. 436 and the westbound I-4 exit ramp to S.R. 434 for two nights.

S.R. 434 under I-4 will close Thursday, November 19 between 9 p.m. and 5 a.m. The eastbound I-4 entrance ramps from S.R. 434 and the westbound I-4 exit ramps to S.R. 434 will both close nightly between 10 p.m. and 6 a.m. from November 19-21.

Please see reverse side for detour routes for motorists on the west side of the I-4 and S.R. 434 interchange.

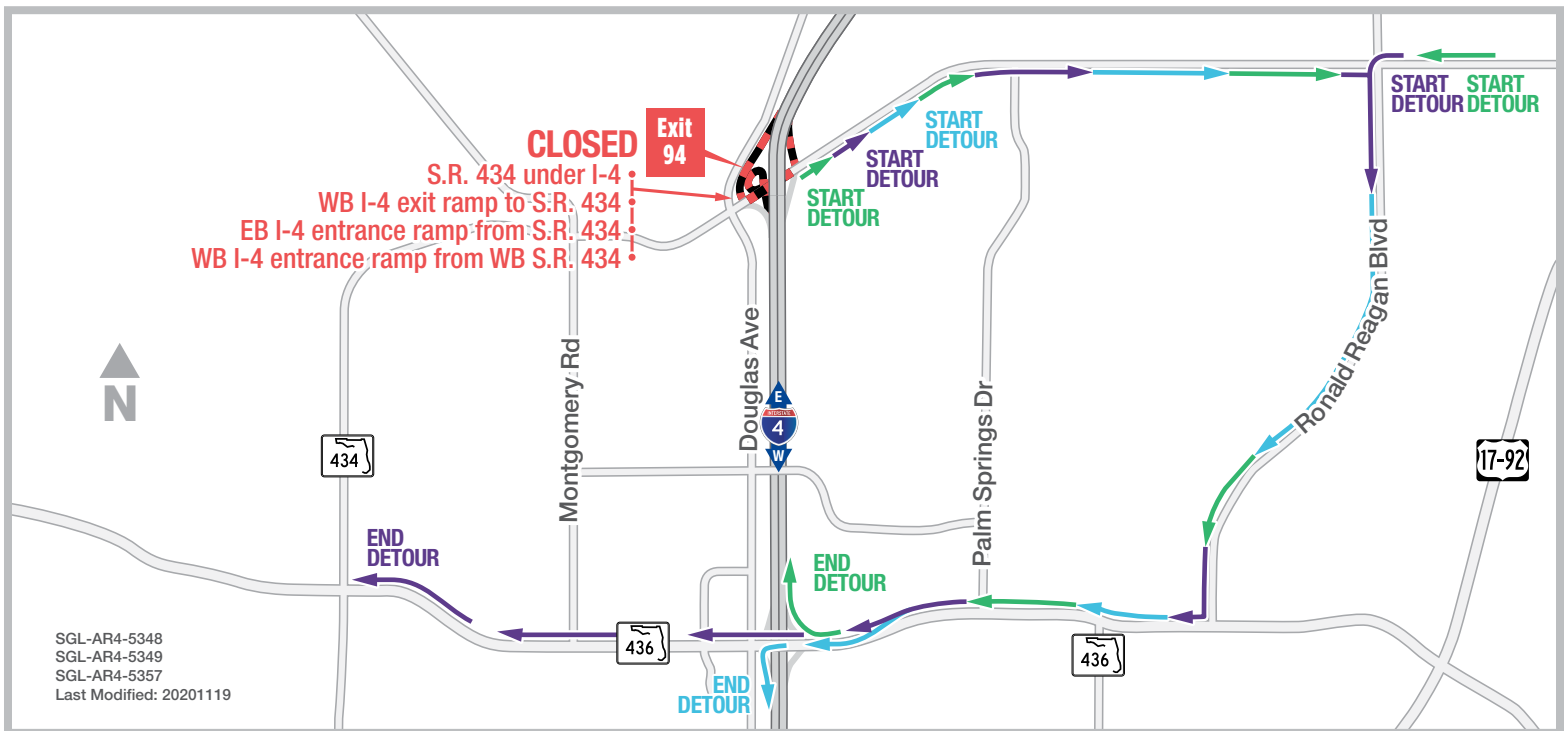

### Traveling S.R. 434 to eastbound I-4:

- Turn south onto Ronald Reagan Boulevard
- Turn right onto S.R. 436
- Follow signage to eastbound I-4

### Traveling S.R. 434 to continue on S.R. 434:

- Turn south onto Ronald Reagan Boulevard
- Turn right onto S.R. 436
- Continue to S.R. 434

### Traveling S.R. 434 to westbound I-4:

- Travel eastbound on S.R. 434, turn right onto Ronald Reagan Boulevard
- Turn right onto S.R. 436
- Follow signage westbound I-4



Sign up for I-4 Construction Updates and Alerts at [I4Ultimate.com](https://I4Ultimate.com)

Learn about design and construction on the next 40 miles of I-4 at [I4Beyond.com](https://I4Beyond.com)