



BUILDING A BETTER I-4

Stay Informed:

- » Project Hotline: 844-ULT-INFO (858-4636)
- » Sign up for email and text alerts at fdot.tips/I4Alerts
- » Follow @i4Ultimate on Twitter
- » Subscribe to our monthly newsletter at fdot.tips/I4News

EASTBOUND I-4 CLOSING BETWEEN MAITLAND BOULEVARD AND STATE ROAD 436 EARLY MORNING APRIL 7

The Florida Department of Transportation (FDOT) is scheduled to temporarily close eastbound Interstate 4 (I-4) between Maitland Boulevard (State Road 414) and State Road (S.R.) 436, from 1 a.m. to 4 a.m. on Wednesday, April 7.

The eastbound I-4 entrance ramps from westbound and eastbound Maitland Boulevard and the eastbound I-4 exit ramp to S.R. 436 will be closed at the same time. The closures require I-4 motorists to detour off the interstate for safety while crews install an overhead sign.

Traveling on eastbound I-4:

- Take Exit 90B to westbound Maitland Boulevard
- Exit to S.R. 434
- Turn right onto S.R. 434
- Turn right onto S.R. 436
- Follow signage to eastbound I-4

Traveling north or south on Keller Road to eastbound I-4:

- Take entrance ramp to westbound Maitland Boulevard
- Follow green detour

Traveling eastbound on Maitland Boulevard to eastbound I-4 :

- Take exit to S.R. 434
- Turn left onto S.R. 434
- Follow green detour

Traveling northbound on S.R. 434 to eastbound I-4:

- Continue on S.R. 434
- Follow green detour

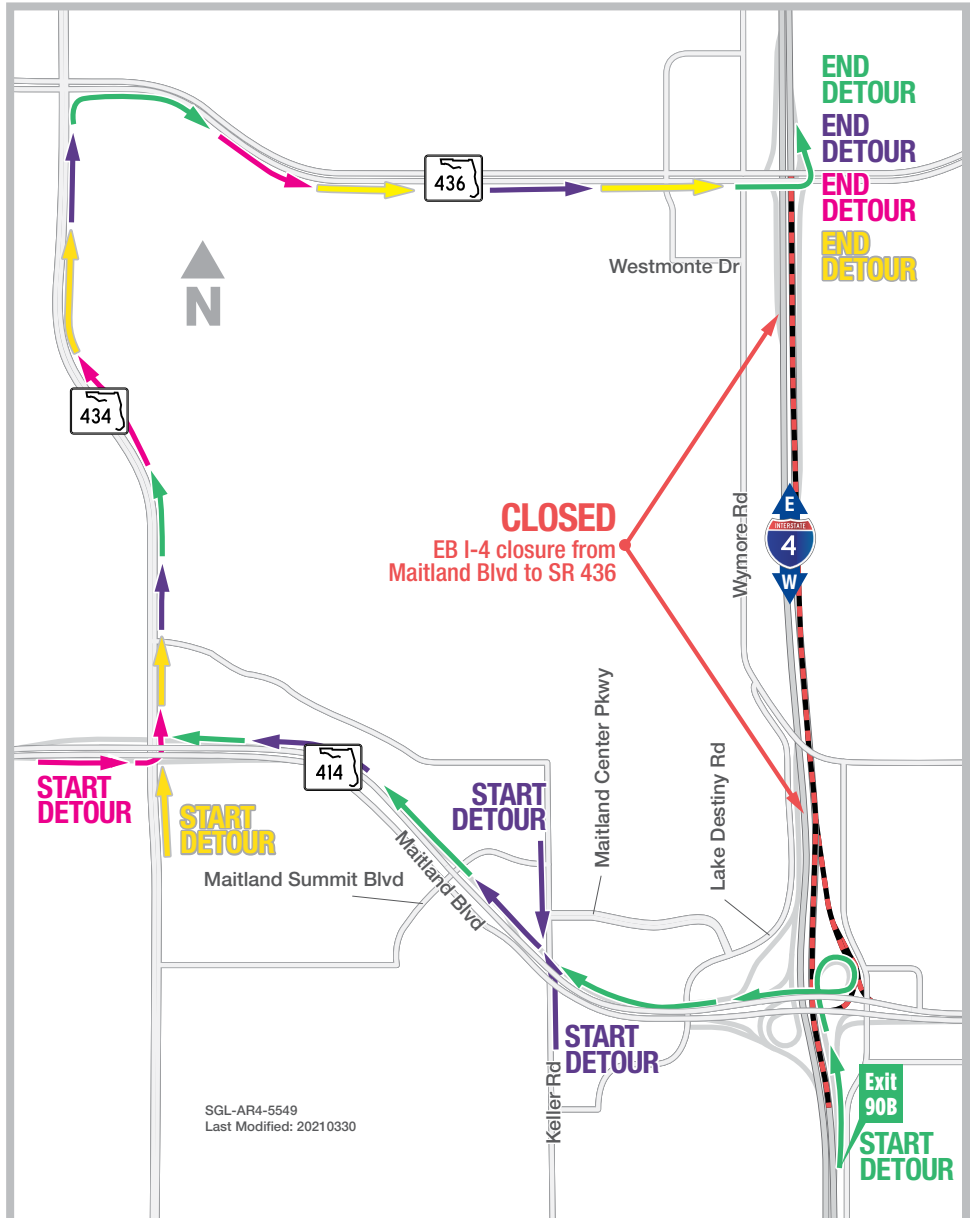

PROJECT INFO

The \$2.3 billion I-4 Ultimate project is reconstructing 21 miles of interstate from west of Kirkman Road to east of State Road 434 in Longwood. For more information about I-4 Ultimate, contact David Parks, I-4 Ultimate Public Information Officer, at 844-ULT-INFO (844-858-4636) or DavidParks@i4Ultimate.com.



Sign up for I-4 Construction Updates and Alerts at I4Ultimate.com

Learn about design and construction on the next 40 miles of I-4 at I4Beyond.com