



# BUILDING A BETTER I-4

### Stay Informed:

- » Project Hotline: 844-ULT-INFO (858-4636)
- » Sign up for email and text alerts at [fdot.tips/I4Alerts](https://fdot.tips/I4Alerts)
- » Follow @i4Ultimate on Twitter
- » Subscribe to our monthly newsletter at [fdot.tips/I4News](https://fdot.tips/I4News)

## EASTBOUND I-4 THROUGH DOWNTOWN ORLANDO CLOSING OVERNIGHT OCTOBER 15

The Florida Department of Transportation (FDOT) is temporarily closing eastbound Interstate 4 (I-4) between South Street and Amelia Street as soon as 11 p.m. October 15 to 5 a.m. October 16. The eastbound I-4 entrance ramp from Anderson Street, and the eastbound and westbound State Road (S.R.) 408 ramps to I-4 will also close during this time frame, though as early as 10 p.m. The closures are necessary to install overhead signs. See reverse side for additional closures and detours.

### Traveling eastbound on I-4:

- Use Exit 83 to South Street
- Continue northbound on Garland Avenue
- Follow signs to eastbound I-4

### Accessing eastbound I-4 from eastbound S.R. 408:

- Use Exit 9 to Orange Blossom Trail (U.S. 441/17-92)
- Turn left onto Orange Blossom Trail
- Turn right onto Colonial Drive
- Follow signs to eastbound I-4

### Accessing eastbound I-4 from westbound S.R. 408:

- Use Exit 9 to Orange Blossom Trail (U.S. 441/17-92)
- Turn right onto Orange Blossom Trail
- Turn right onto Colonial Drive
- Follow signs to eastbound I-4

### Accessing westbound I-4 from eastbound S.R. 408:

- Use Exit 9 to Orange Blossom Trail
- Turn right onto Orange Blossom Trail
- Follow signs to westbound I-4

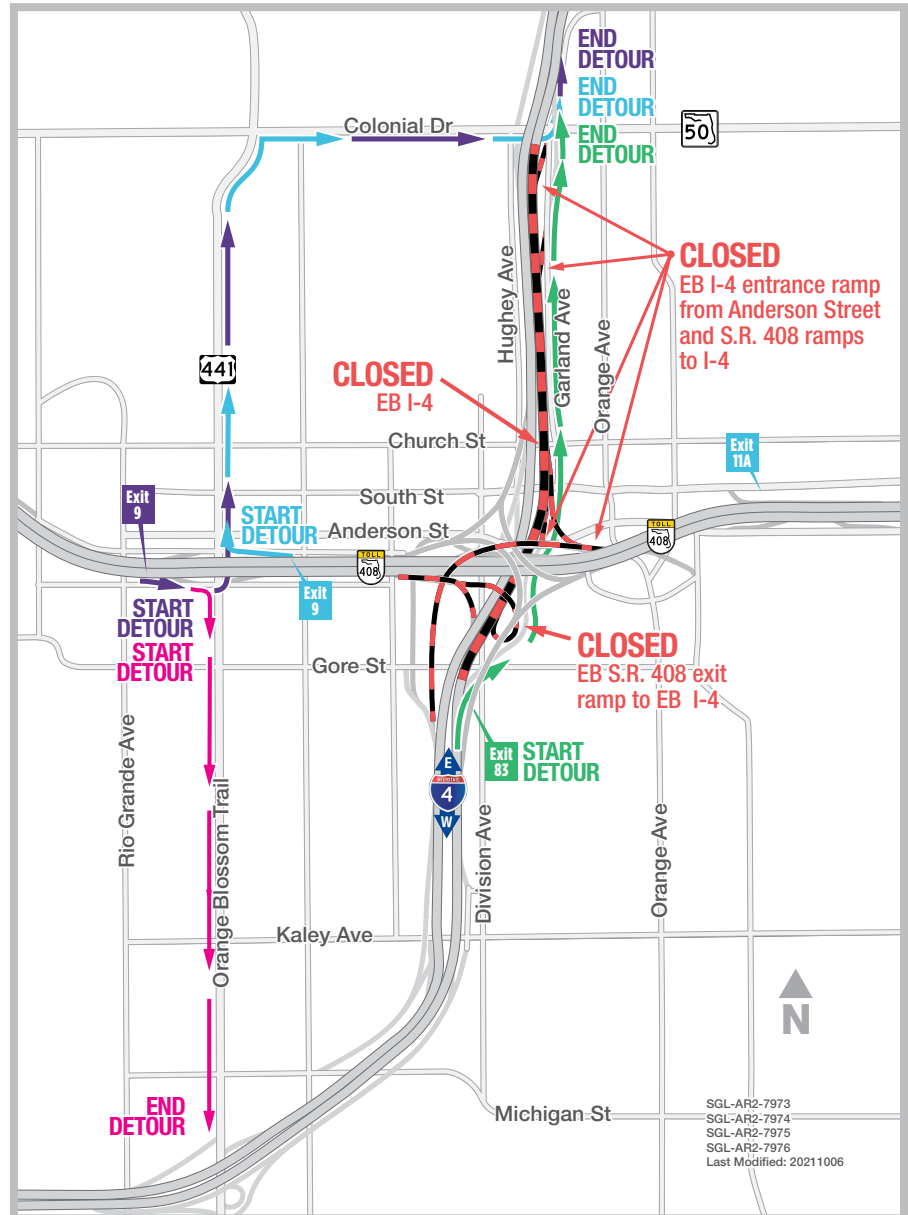

Sign up for I-4 Construction Updates and Alerts at [I4Ultimate.com](https://I4Ultimate.com)

Learn about design and construction on the next 40 miles of I-4 at [I4Beyond.com](https://I4Beyond.com)



# BUILDING A BETTER I-4

## Stay Informed:

- » Project Hotline: 844-ULT-INFO (858-4636)
- » Sign up for email and text alerts at [fdot.tips/I4Alerts](https://fdot.tips/I4Alerts)
- » Follow @i4Ultimate on Twitter
- » Subscribe to our monthly newsletter at [fdot.tips/I4News](https://fdot.tips/I4News)

## EASTBOUND I-4 THROUGH DOWNTOWN ORLANDO CLOSING OVERNIGHT OCTOBER 15

The Florida Department of Transportation (FDOT) is temporarily closing eastbound Interstate 4 (I-4) between South Street and Amelia Street as soon as 11 p.m. October 15 to 5 a.m. October 16. The eastbound I-4 entrance ramp from Anderson Street, and the eastbound and westbound State Road (S.R.) 408 ramps to I-4 will also close during this time frame, though as early as 10 p.m. The closures are necessary to install overhead signs. See reverse side for additional closures and detours.

### Accessing eastbound I-4 from eastbound Anderson Street:

- Turn left onto Division Avenue
- Turn right onto Washington Street
- Turn left onto Garland Avenue
- Follow signs to eastbound I-4

### Accessing eastbound I-4 from westbound Anderson Street:

- Turn right onto Division Avenue
- Turn right onto Washington Street
- Turn left onto Garland Avenue
- Follow signs to eastbound I-4

### Accessing westbound I-4 from westbound S.R. 408:

- Use Exit 9 to Orange Blossom Trail
- Turn left onto Orange Blossom Trail
- Follow signs to westbound I-4

### PROJECT INFO

The \$2.3 billion I-4 Ultimate project is reconstructing 21 miles of interstate from west of Kirkman Road to east of State Road 434 in Longwood. For more information about I-4 Ultimate, contact David Parks, I-4 Ultimate Community Outreach Specialist, at 844-ULT-INFO (844-858-4636) or [DavidParks@i4Ultimate.com](mailto:DavidParks@i4Ultimate.com).

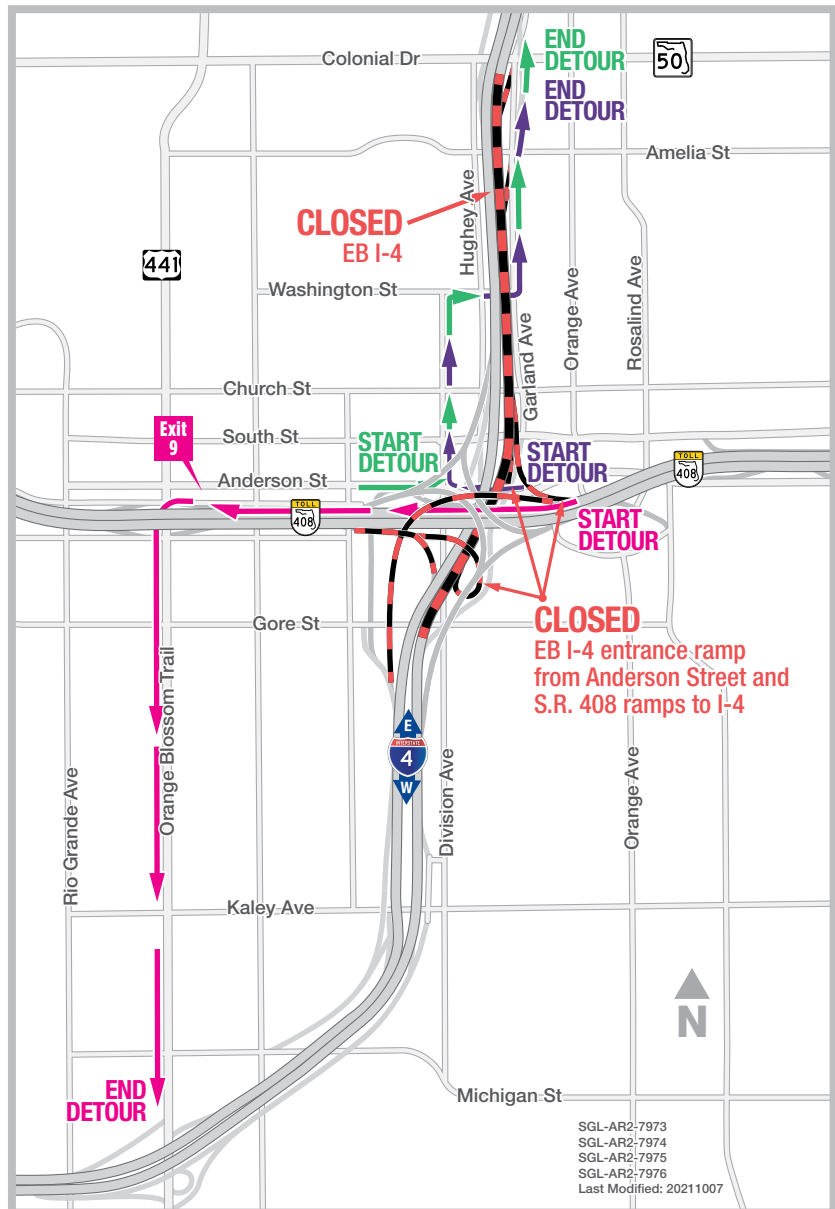

Sign up for I-4 Construction Updates and Alerts at [I4Ultimate.com](https://I4Ultimate.com)

Learn about design and construction on the next 40 miles of I-4 at [I4Beyond.com](https://I4Beyond.com)