



July 23, 2015

Jessica Keane, 386-943-5473
jessica.keane@dot.state.fl.us

Upcoming temporary closure for Westmoreland Drive under SR 408

ORLANDO — As part of the I-4 Ultimate project, the Florida Department of Transportation is temporarily closing South Westmoreland Drive, directly under SR 408, beginning on Monday, July 27, at 7 a.m. The closure will continue every day from 7 a.m. to 5 p.m. until Friday, August 21. The closure is necessary for bridge work to improve the I-4/SR 408 interchange. For more information and detour map please see attached flyer.

STARTING: Northbound South Westmoreland Drive

- Traveling north on South Westmoreland Drive, begin detour by turning right on Gore Street.
- Turn left on South Parramore Avenue.
- Turn left on South Street to proceed to end of detour at South Westmoreland Drive.

STARTING: Southbound South Westmoreland Drive

- Traveling south on South Westmoreland Drive, begin detour by turning left on Anderson Street.
- Turn right on South Parramore Avenue.
- Turn right on Gore Street to proceed to end of detour at South Westmoreland Drive.

The \$2.3 billion I-4 Ultimate project is reconstructing 21 miles of interstate from west of Kirkman Road to east of State Road 434 in Longwood. For more information about I-4 Ultimate, contact David Parks, I-4 Ultimate Public Information Officer, at 844-ULT-INFO (844-858-4636) or DavidParks@I4Ultimate.com.

For media inquiries please contact the Public Information office, Jessica Keane 386-943-5473 / Jessica.Keane@dot.state.fl.us or David Parks at the contact information above.

Celebrating 100 Years of Innovation, Mobility and Economic Development

www.dot.state.fl.us/agencyresources/anniversary/

I4Ultimate.com | @MyFDOT_CFL | Facebook.com/MyFDOTCFL



BUILDING A BETTER I-4

Stay Informed:

- » Project Hotline: 844-ULT-INFO (858-4636)
- » Sign up for email and text alerts at I4Ultimate.com
- » For real-time traffic conditions call 511, download Florida 511 mobile apps or visit FL511.com
- » Follow @i4ultimate on Twitter

IMPORTANT INFORMATION FOR THE PARRAMORE COMMUNITY

SOUTH WESTMORELAND DRIVE UNDER STATE ROAD 408 IS CLOSING MONDAY, JULY 27, to FRIDAY, AUGUST 21, FROM 7 A.M. TO 5 P.M. EACH DAY.

As part of the I-4 Ultimate project, the Florida Department of Transportation is temporarily closing South Westmoreland Drive, directly under S.R. 408, beginning on Monday, July 27, at 7 a.m. The closure will continue every day from 7 a.m. to 5 p.m. until Friday, August 21. The closure is necessary for bridge work to improve the I-4/S.R. 408 interchange.

STARTING: Northbound South Westmoreland Drive

Traveling north on South Westmoreland Drive, begin detour by turning right on Gore Street. Turn left on South Parramore Avenue. Turn left on South Street to proceed to end of detour at South Westmoreland Drive.

STARTING: Southbound South Westmoreland Drive

Traveling south on South Westmoreland Drive, begin detour by turning left on Anderson Street. Turn right on South Parramore Avenue. Turn right on Gore Street to proceed to end of detour at South Westmoreland Drive.

PROJECT INFO

The \$2.3 billion I-4 Ultimate project is reconstructing 21 miles of interstate from west of Kirkman Road to east of State Road 434 in Longwood. For more information about I-4 Ultimate, contact David Parks, I-4 Ultimate Public Information Officer, at 844-ULT-INFO (844-858-4636) or DavidParks@I4Ultimate.com.

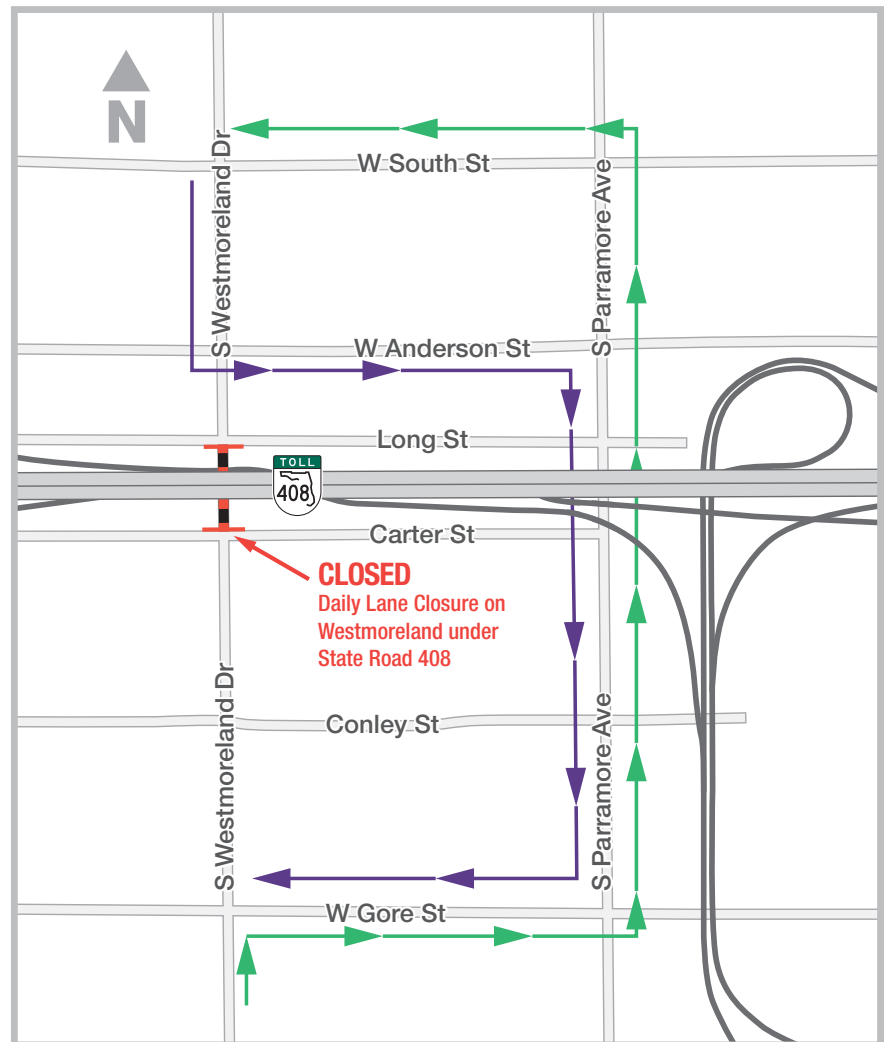

Sign up for I-4 Construction Updates and Alerts at I4Ultimate.com
Get real-time traffic and incident alerts at FL511.com

